



**Montageanleitung** | Mounting instructions

# DisplayLift

**Wandmontage** | Wall installation  
**Art.-Nr.** | Ref.No. 4013 000300

**Bodenplatte** | Floor plate  
**Art.-Nr.** | Ref.No. 4013 000110

**Mobiler Rollständer** | Mobile stand  
**Art.-Nr.** | Ref.No. 4013 000301

## Inhaltsverzeichnis

1. Grundlegende Sicherheitshinweise .....	3
2. Allgemeine Beschreibung Wandmontage .....	4
2.1 Lieferumfang .....	5
2.2 Benötigtes Werkzeug .....	5
2.3 Montage .....	6
3. Allgemeine Beschreibung Bodenständer .....	10
3.1 Lieferumfang .....	11
3.2 Benötigtes Werkzeug .....	11
3.3 Montage .....	12
4. Allgemeine Beschreibung Rollständer .....	13
4.1 Lieferumfang .....	14
4.2 Benötigtes Werkzeug .....	14
4.3 Montage .....	15
5. Abmessungen .....	19
6. Spezifikationen .....	20

## Table of contents

1. Basic safety instructions .....	3
2. General description installation .....	4
2.1 Scope of delivery .....	5
2.2 Required tools .....	5
2.3 Assembling .....	6
3. General description Floor stand .....	10
3.1 Scope of delivery .....	11
3.2 Required tools .....	11
3.3 Assembling .....	12
4. General description Mobile stand .....	13
4.1 Scope of delivery .....	14
4.2 Required tools .....	14
4.3 Assembling .....	15
5. Dimensions .....	19
6. Specifications .....	20

# 1. Sicherheitshinweise - Safety instructions

## **Achtung**

- Bitte diese Anleitung sorgfältig durchlesen und aufbewahren.
- Aufbau und Montage sollen durch qualifizierte Personen durchgeführt werden.
- Der DisplayLift darf nur mit den dafür vorgesehenen Flachbild-Monitoren, in geschlossenen, geraden, ebenen und trockenen Räumen verwendet werden. Das Display darf ein Gewicht von 90 kg und die Größe von 86 Zoll nicht überschreiten. Bitte beachten Sie auch die Anleitung des anzubringenden Displays. Die Schrauben müssen mindestens 3-5 Umdrehungen ins Gewinde des Monitors eingedreht werden (Herstellerangaben beachten!).
- Bedingt durch die Form der Bodenplatte bzw. des Rollständers besteht eine Stolpergefahr bei der Bedienung bzw. bei der Installation.
- Verlegen Sie die Leitungen zum Gerät so, dass sie keine Stolpergefahr darstellen und nicht beschädigt werden können.
- Vor jedem Transport des Rollständers müssen sämtliche Kabel zum Displayständer gelöst werden. Fahren Sie den Lift in die unterste Position bevor Sie ihn bewegen.
- Achten Sie beim Transport darauf, dass der Rollständer nicht kippt (Verletzungsgefahr!).
- Die Feststeller der beiden vorderen Lenkrollen müssen vor der Nutzung fixiert werden, um einen sicheren Stand zu gewährleisten.
- Prüfen Sie vor der Montage die Wandbeschaffenheit, sowie die in der Wand befindlichen Rohr- und Elektroleitungen. Verwenden Sie zur Montage ausschließlich geeignetes, ausreichend dimensioniertes Montagematerial entsprechend den einschlägigen Normen für Befestigungstechnik.

## **Attention**

- Please read these instructions carefully and keep them for future reference.
- Assembly shall be done by qualified persons only.
- The DisplayLift may only be used indoor in flat and dry rooms with flat-screen monitors provided for this purpose. The weight of the display must not exceed 90 kg and a size of 86 inch. Please also note the instructions for the display to be installed. The screws must be turned into the threads of the monitor for at least 3-5 revolutions (Please, note the manufacturer's instructions!).
- Due to the shape of the base plate or the roller stand, there is a risk of tripping during operation or installation.
- Guide the cables to the DisplayLift in a way that they do not pose a risk of tripping and cannot be damaged.
- Prior to every transport of the mobile stand, all cables must be removed.
- Bring the lift to the lowest position before moving it to avoid tilting. (Risk of injury).
- The locks of the two front swivel castors must be fixed before use to ensure a save stand.
- Before installation, check the wall for its condition as well as for pipes and electrical cables. For assembly, use only suitable, sufficiently dimensioned installation material in accordance with the relevant standards.

## 2. Montageanleitung – Mounting instructions

Wandmontage / Wall installation

Art.-Nr./Ref.No. 4013000300

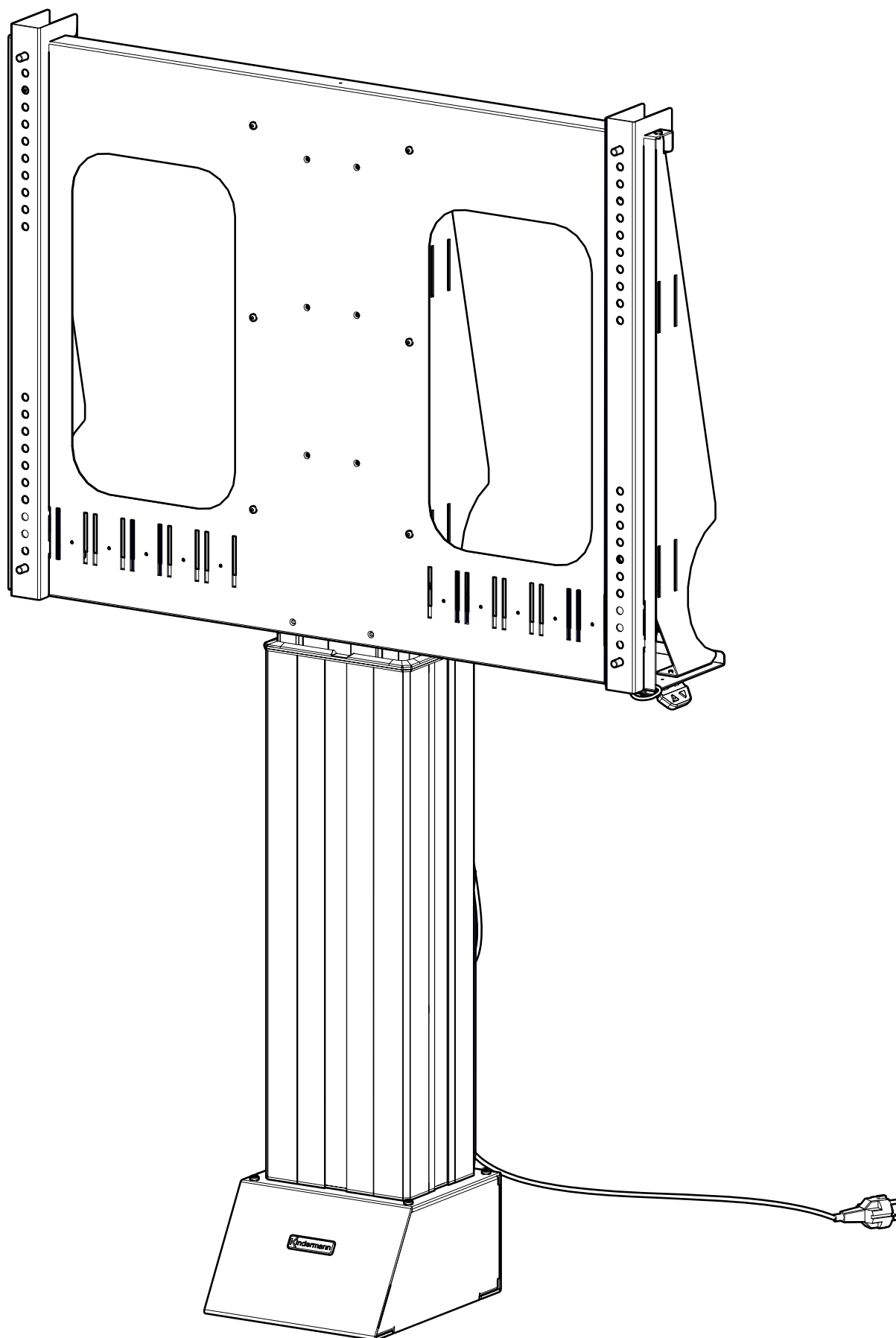

## 2.1 Lieferumfang – Scope of delivery

Art.-Nr./ Ref.No. 4013000300

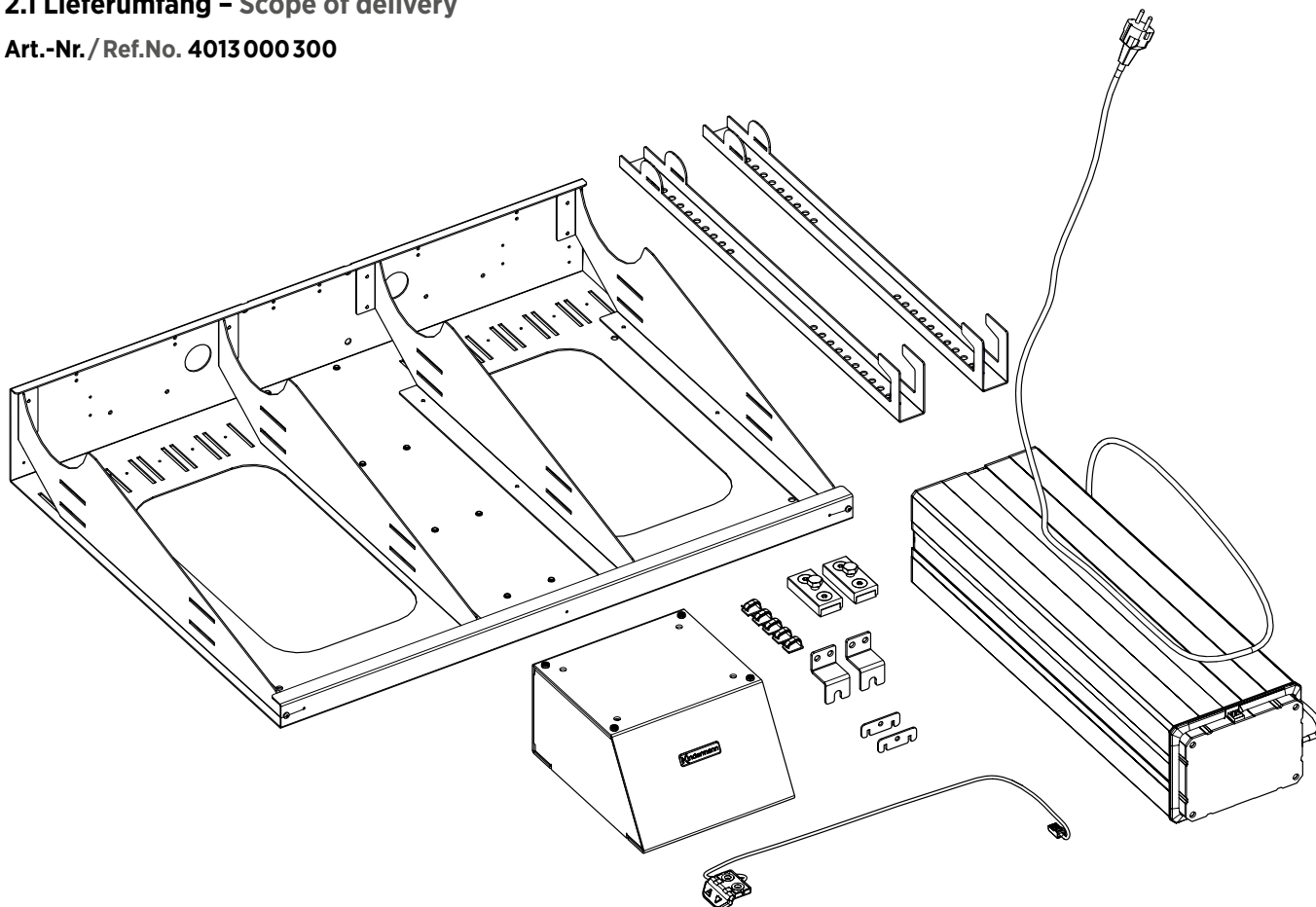

2 x 4,3mm



4 x 6,4mm



16 x 8,4mm

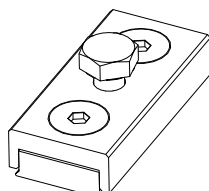

(vormontiert/  
preassembled)

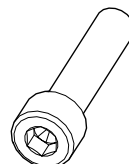

8 x M8x35mm  
(gewindeformend/  
thread-forming)



8 x M8x16mm



2 x M4x8mm



2 x M4x10mm



4 x M6x16mm

## 2.2 Benötigtes Werkzeug – Required tools



3, 5, 6



TX 20



13



## 2.3 Montage - Assembling

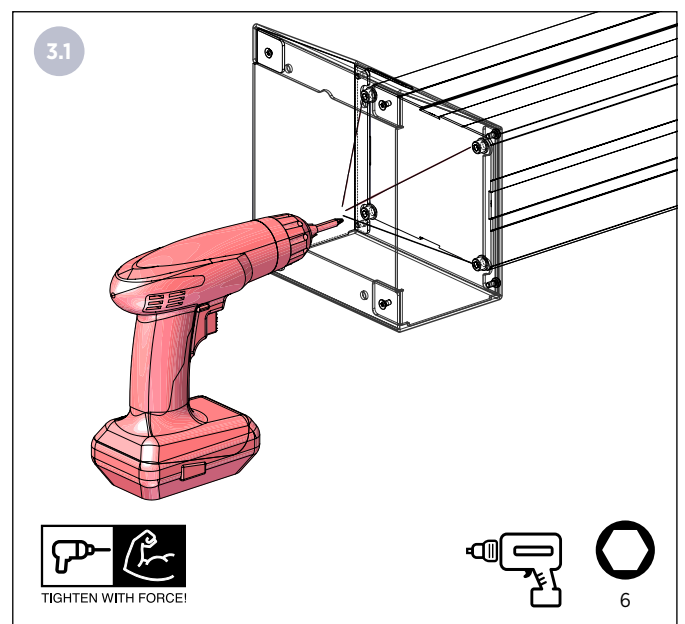
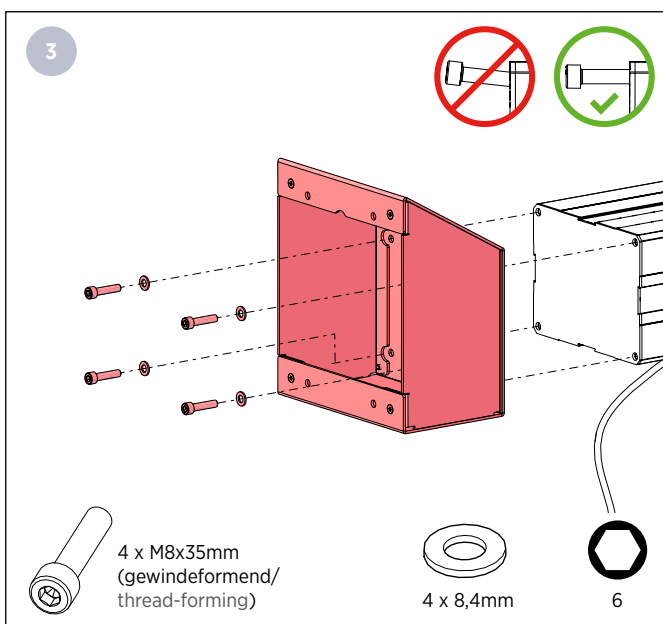
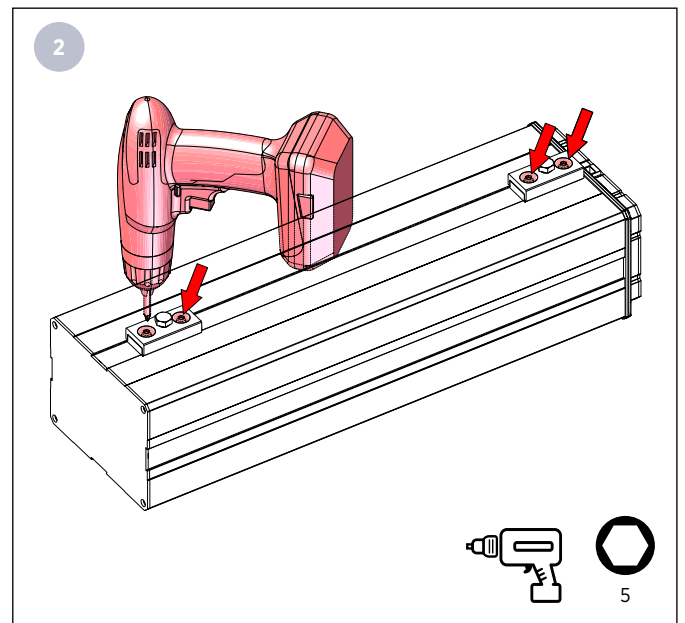
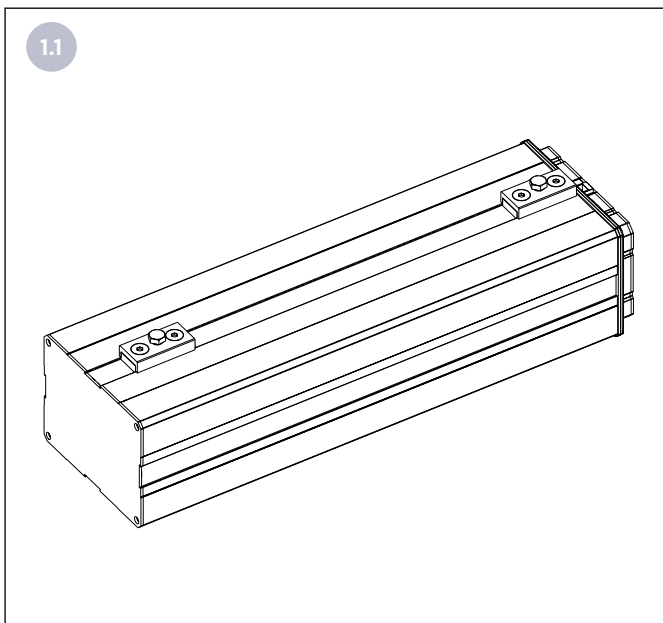
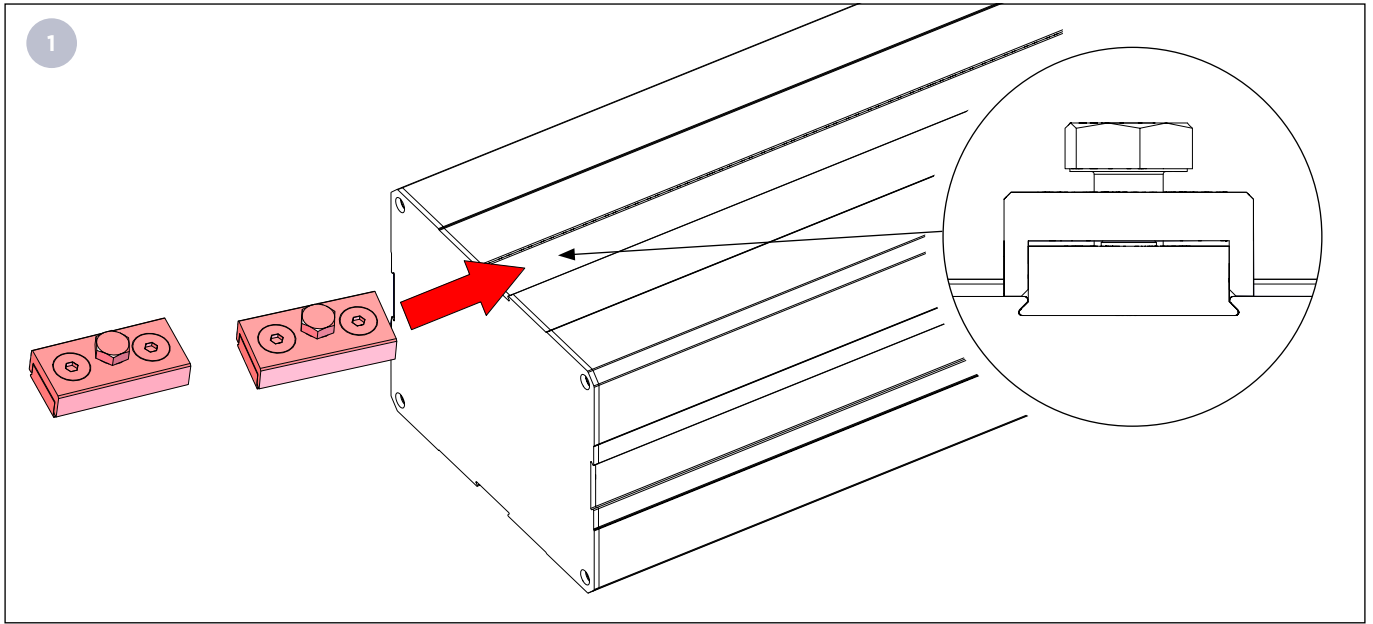

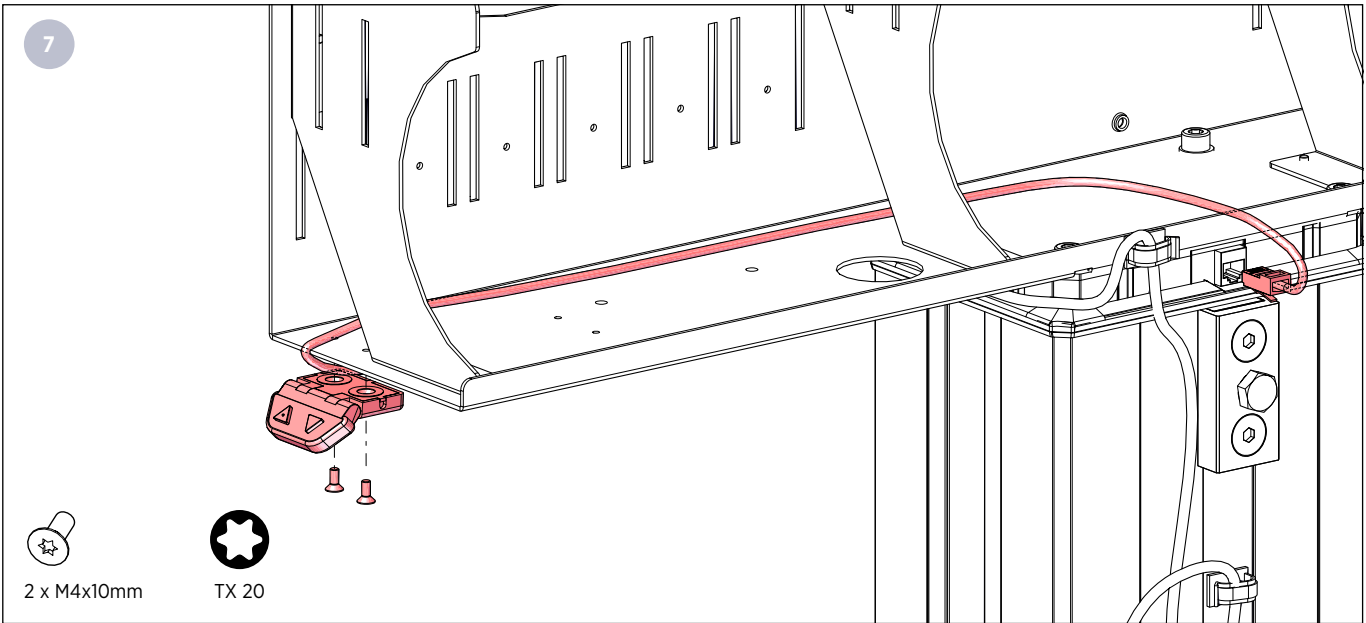
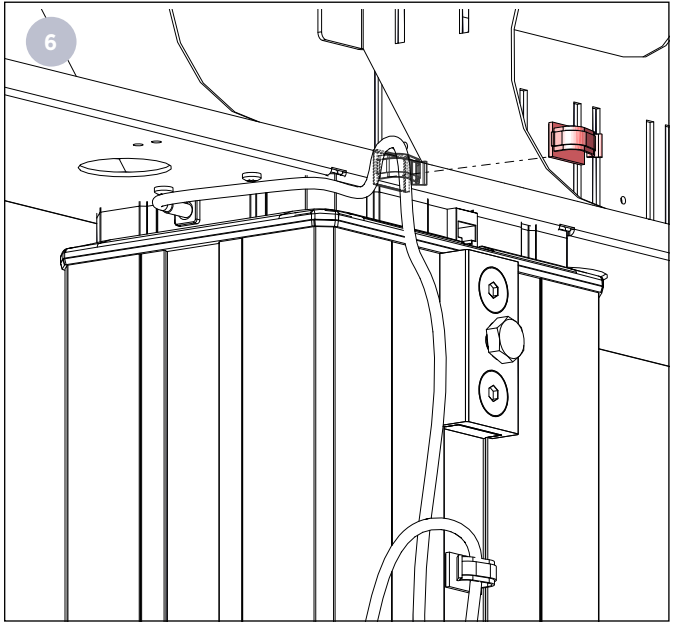
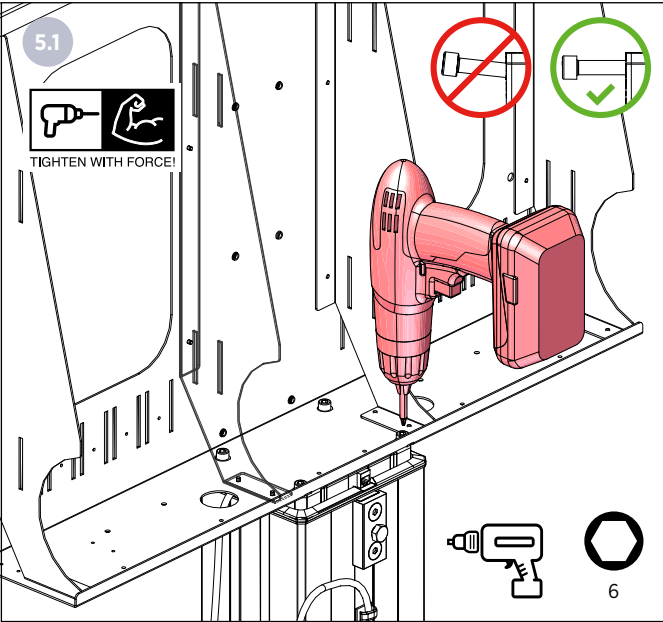
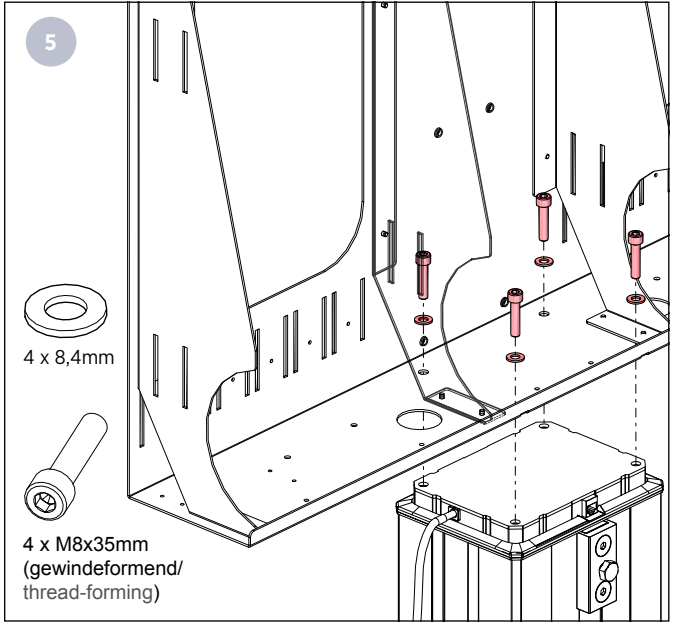
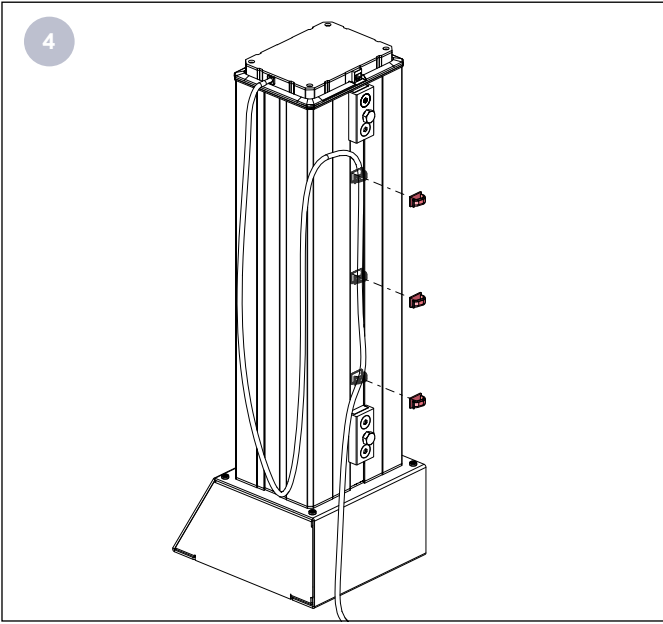

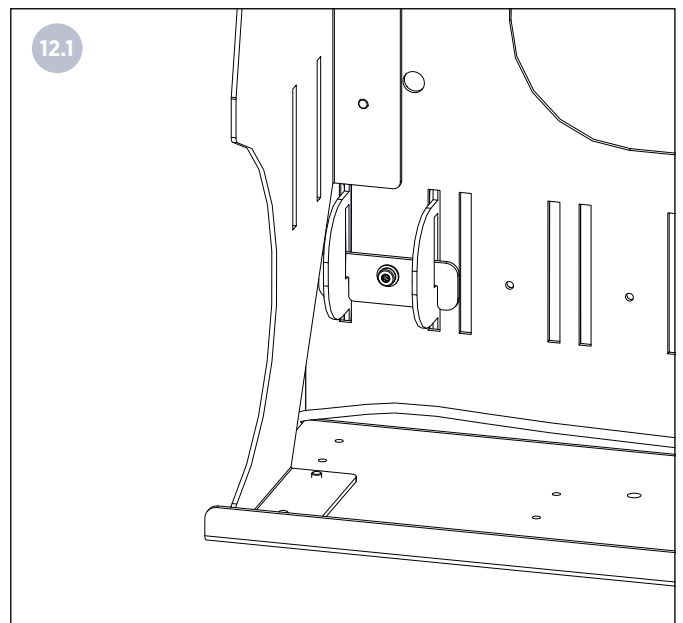
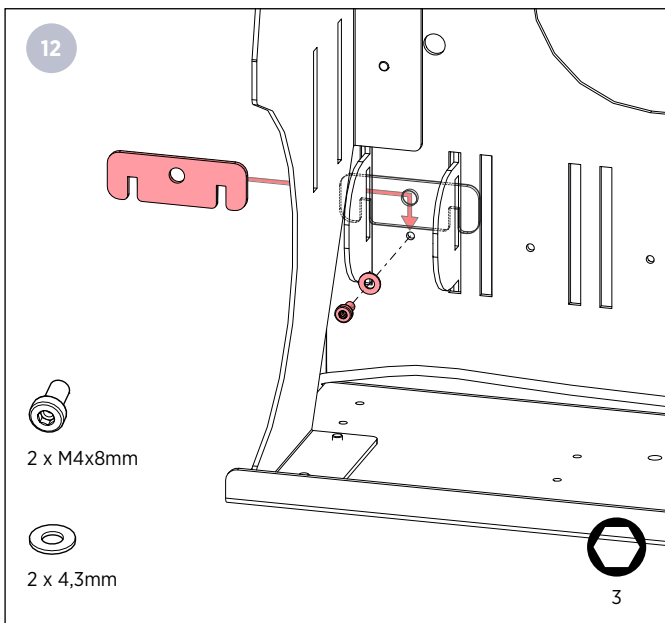
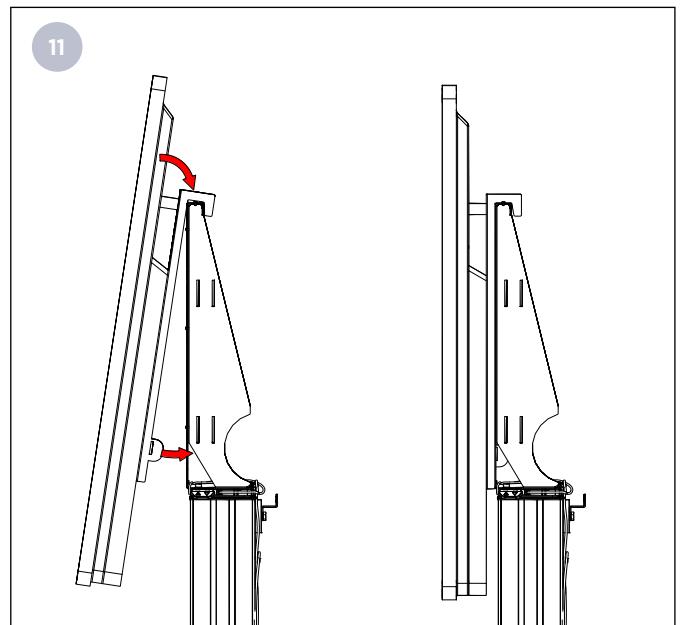
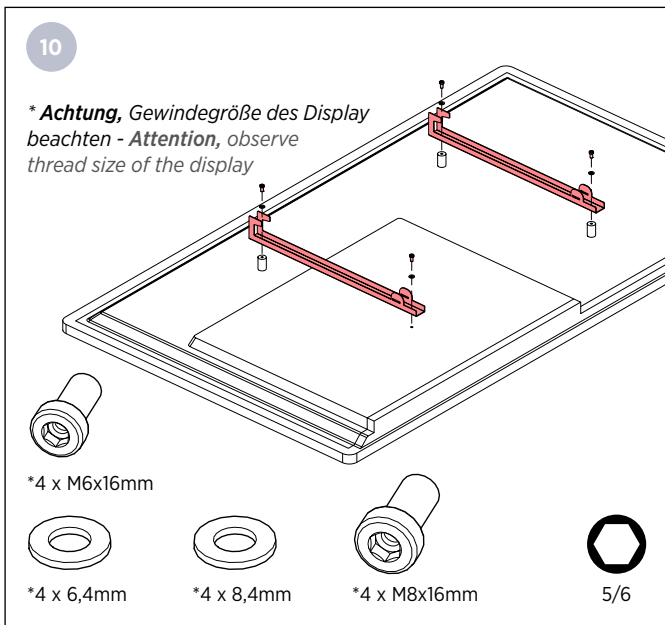
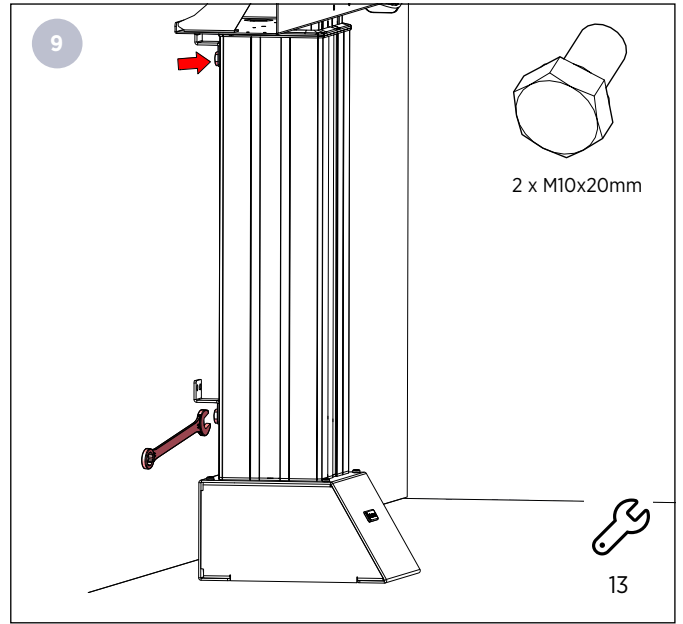
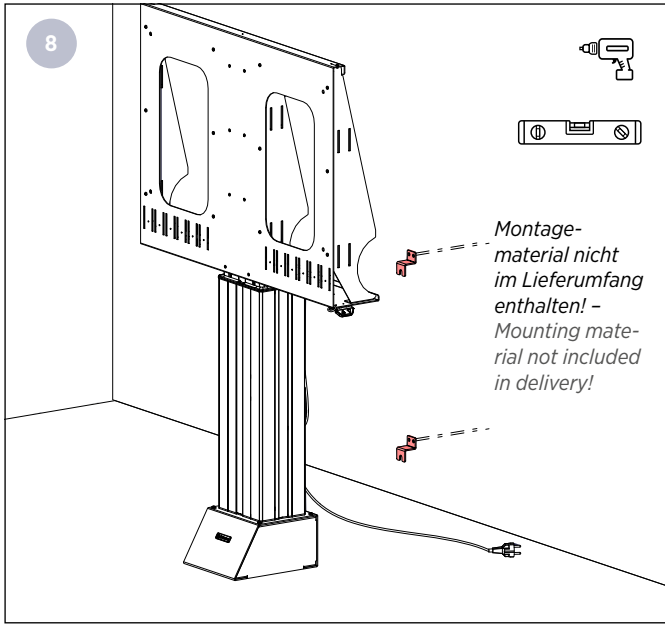



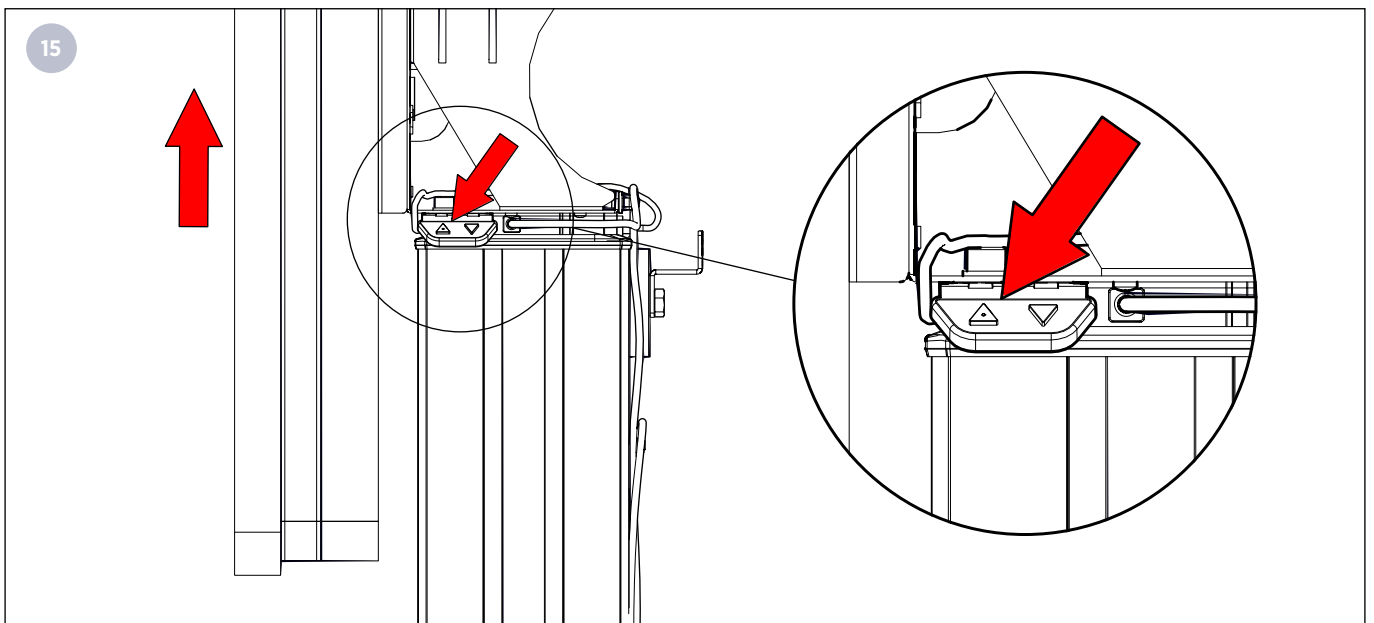
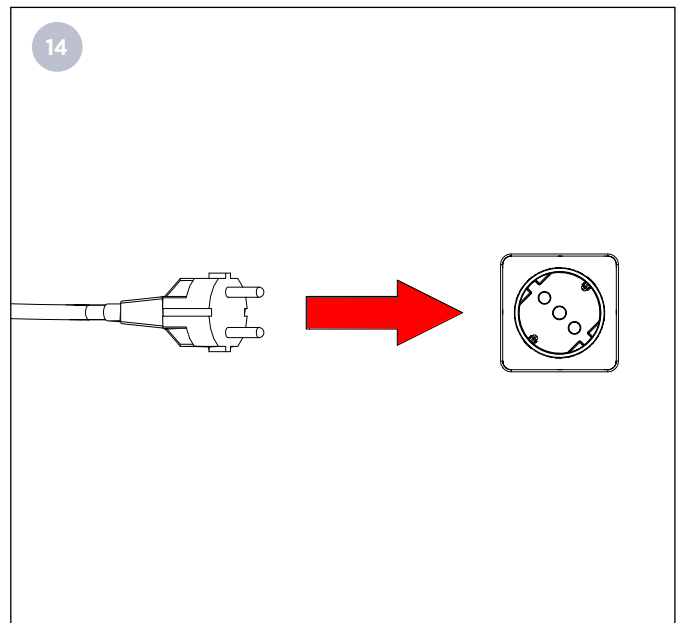
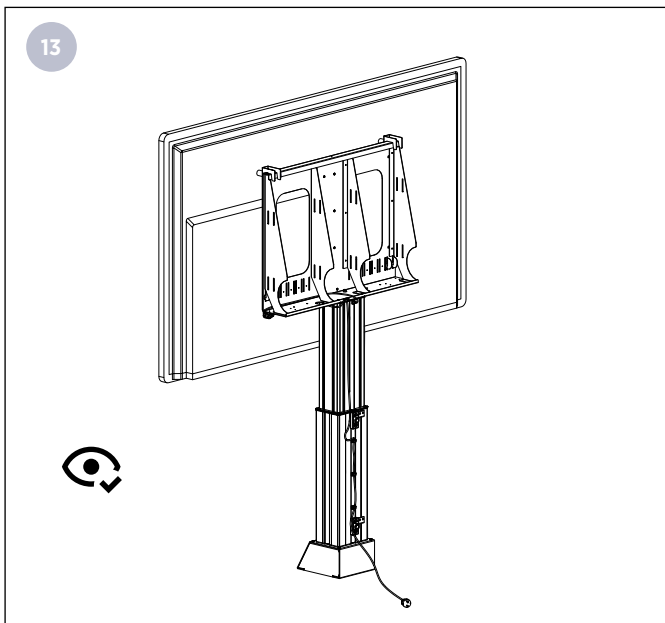
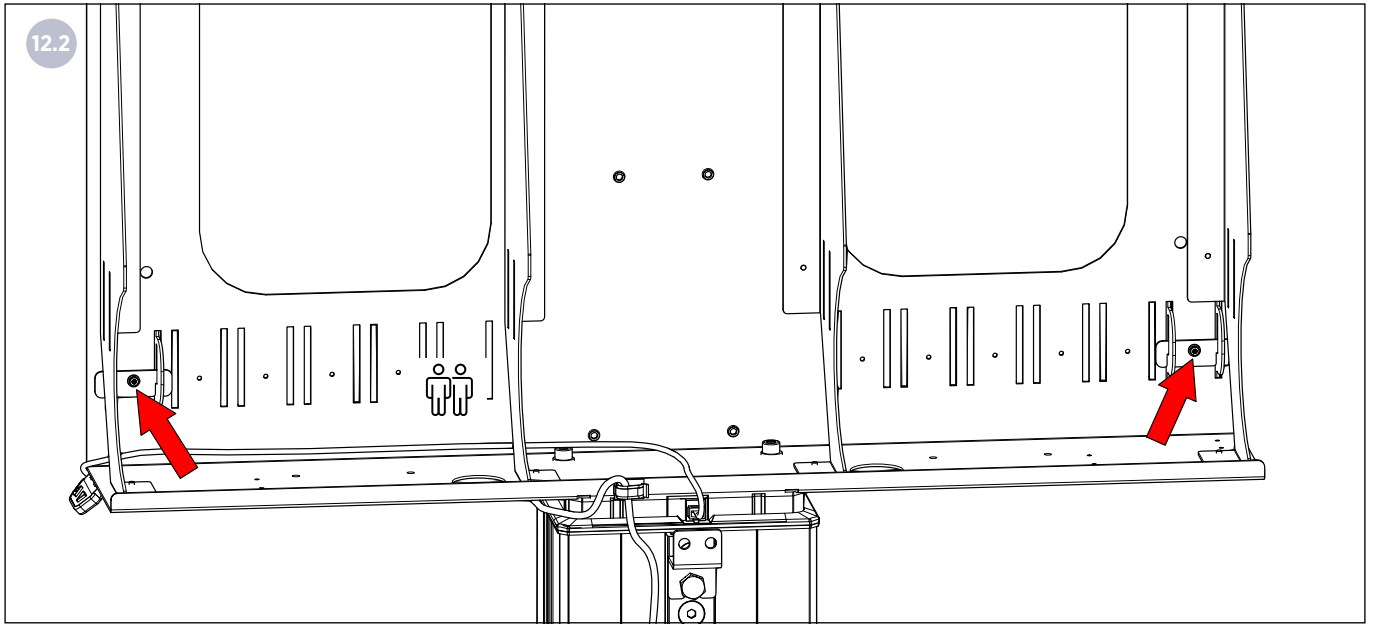

### 3. Montageanleitung – Mounting instructions

Bodenständer / Floor stand

Art.-Nr./Ref.No. 4013000110

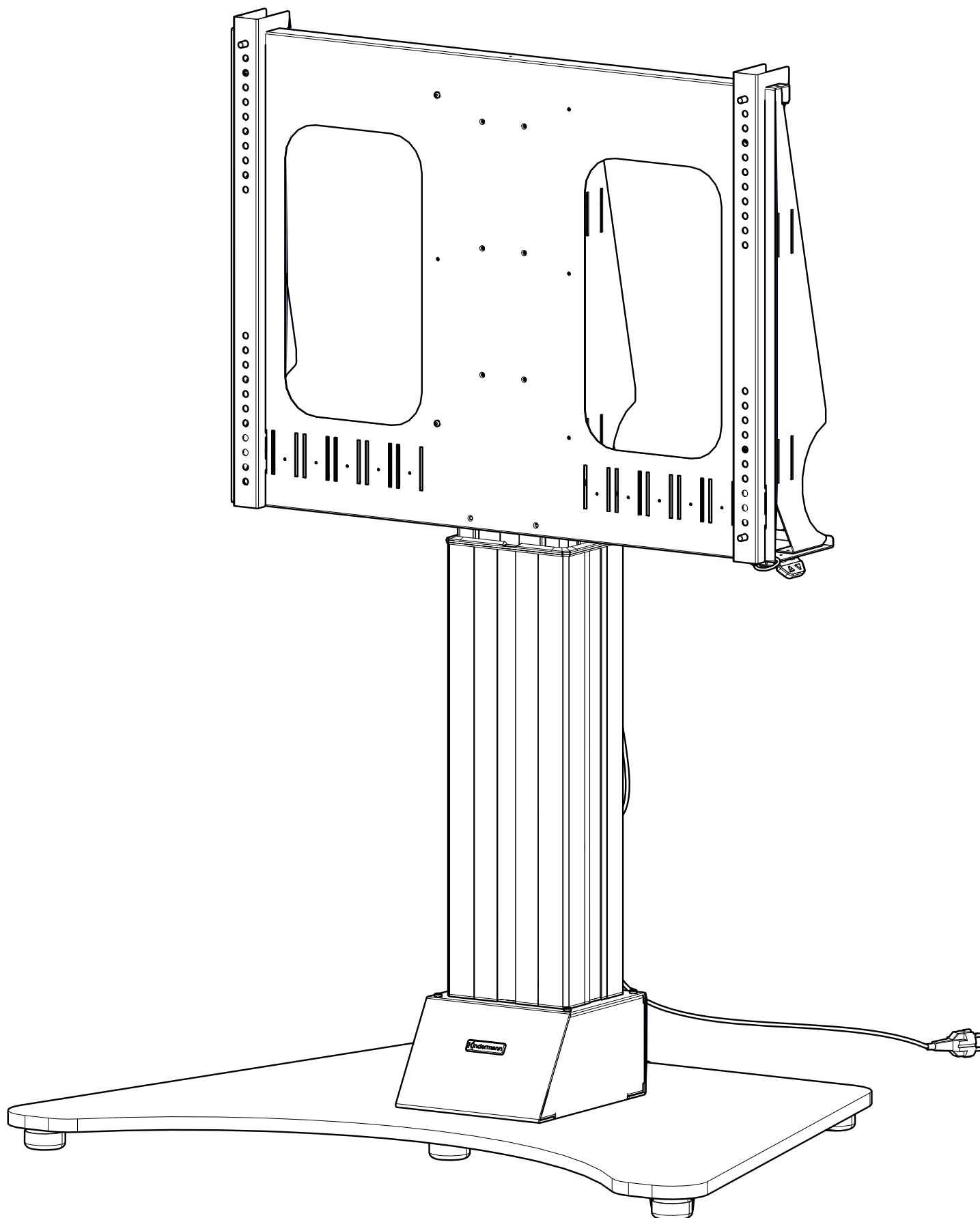

### 3.1 Lieferumfang – Scope of delivery

Art.-Nr./ Ref.No. 4013000110

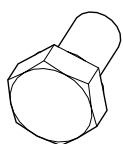
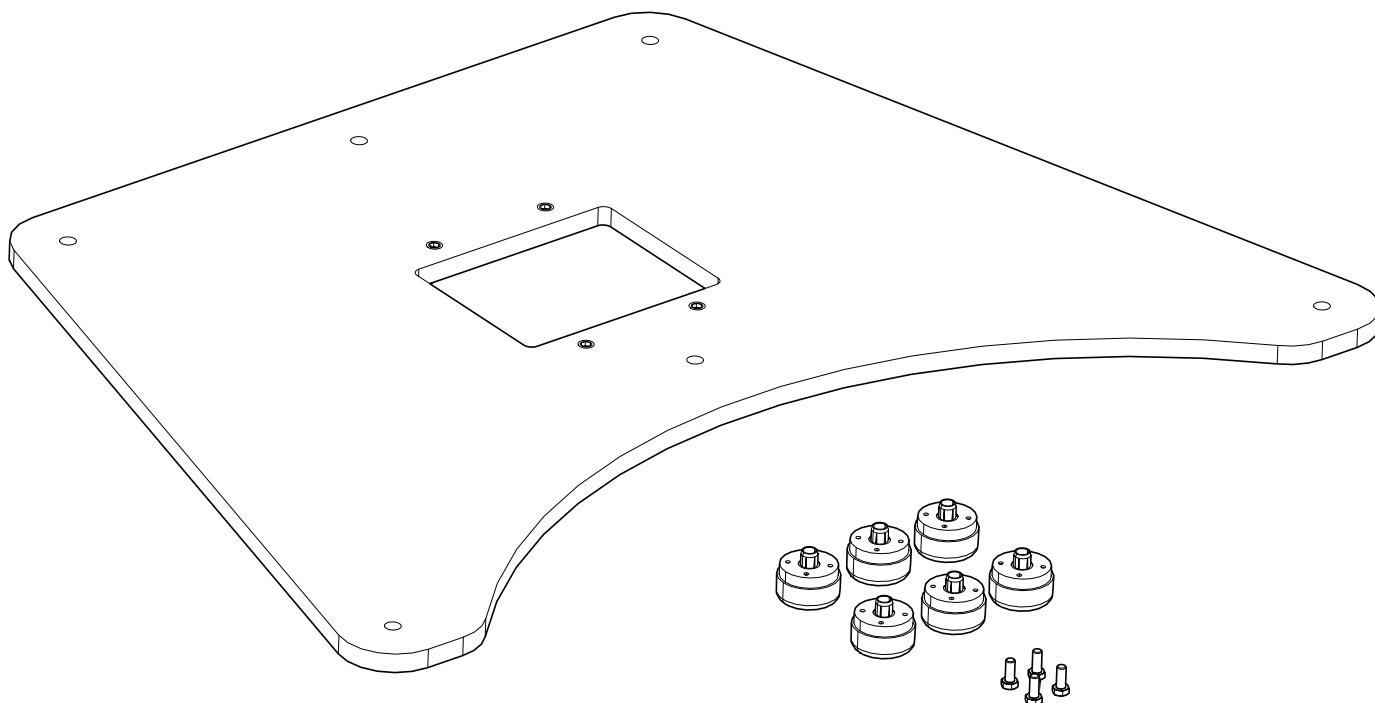

4 x M8x20mm

### 3.2 Benötigtes Werkzeug – Required tools



13

### 3.3 Montage - Assembling

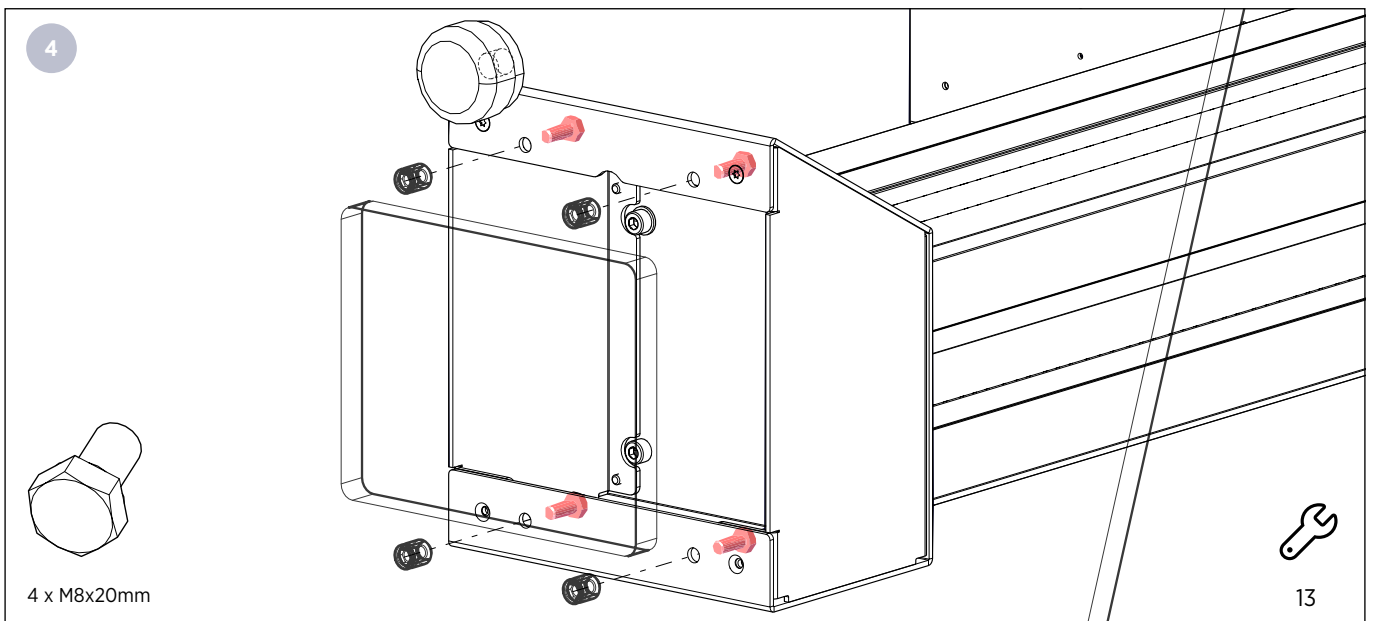
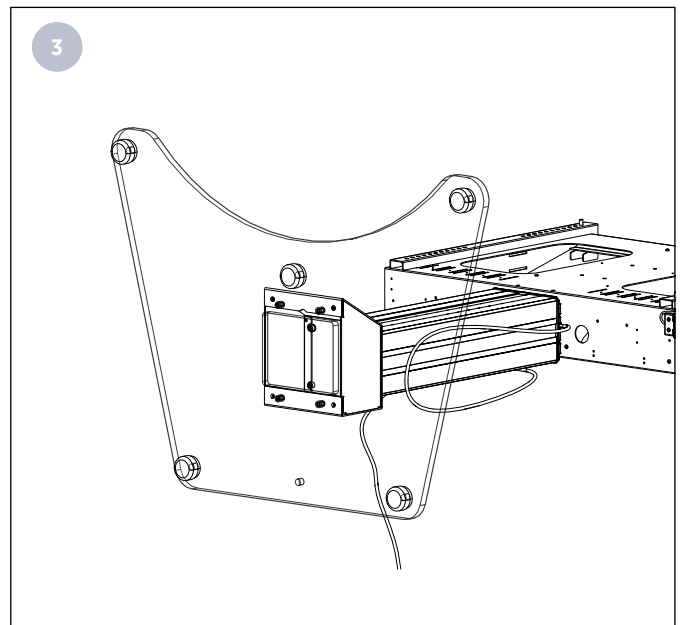
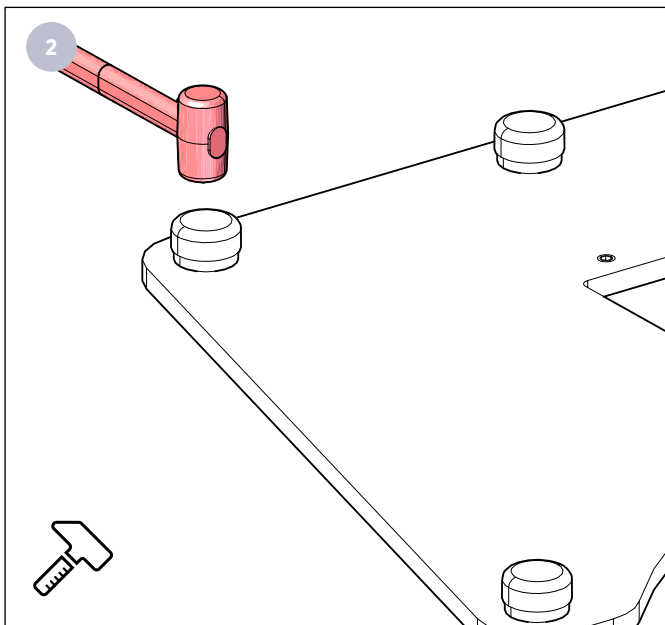
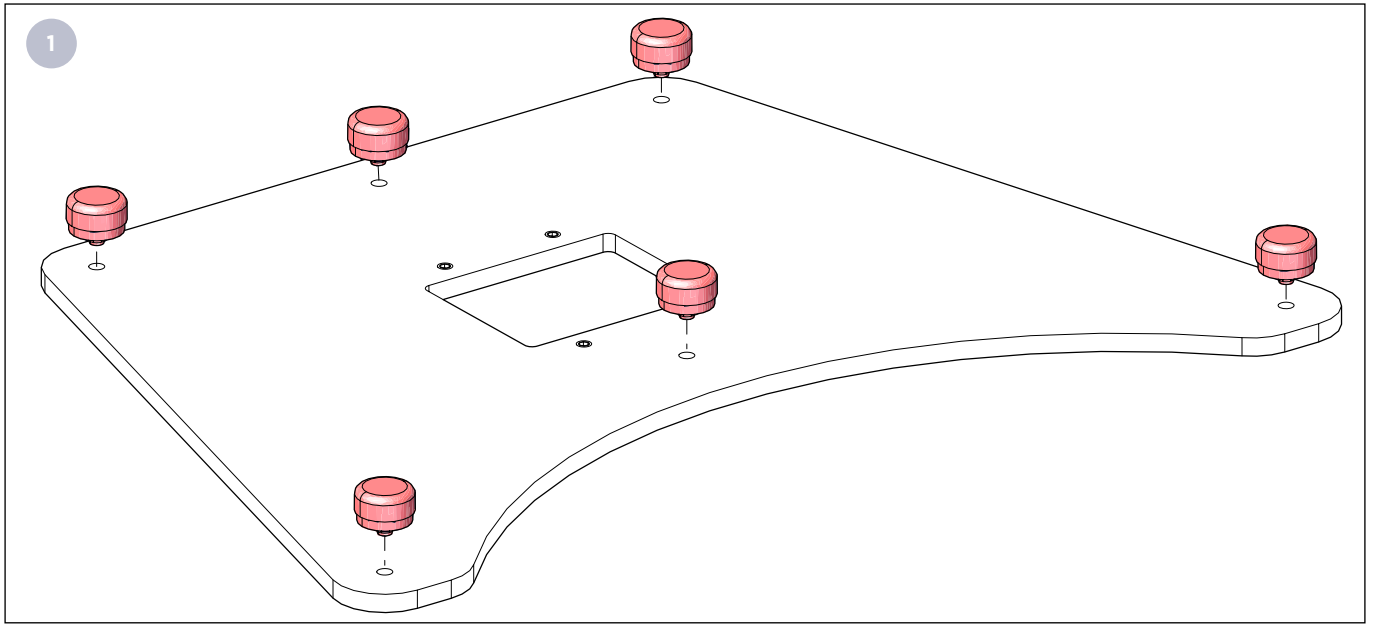

## 4. Montageanleitung – Mounting instructions

Rollständer / Mobile stand

Art.-Nr./Ref.No. 4013000301

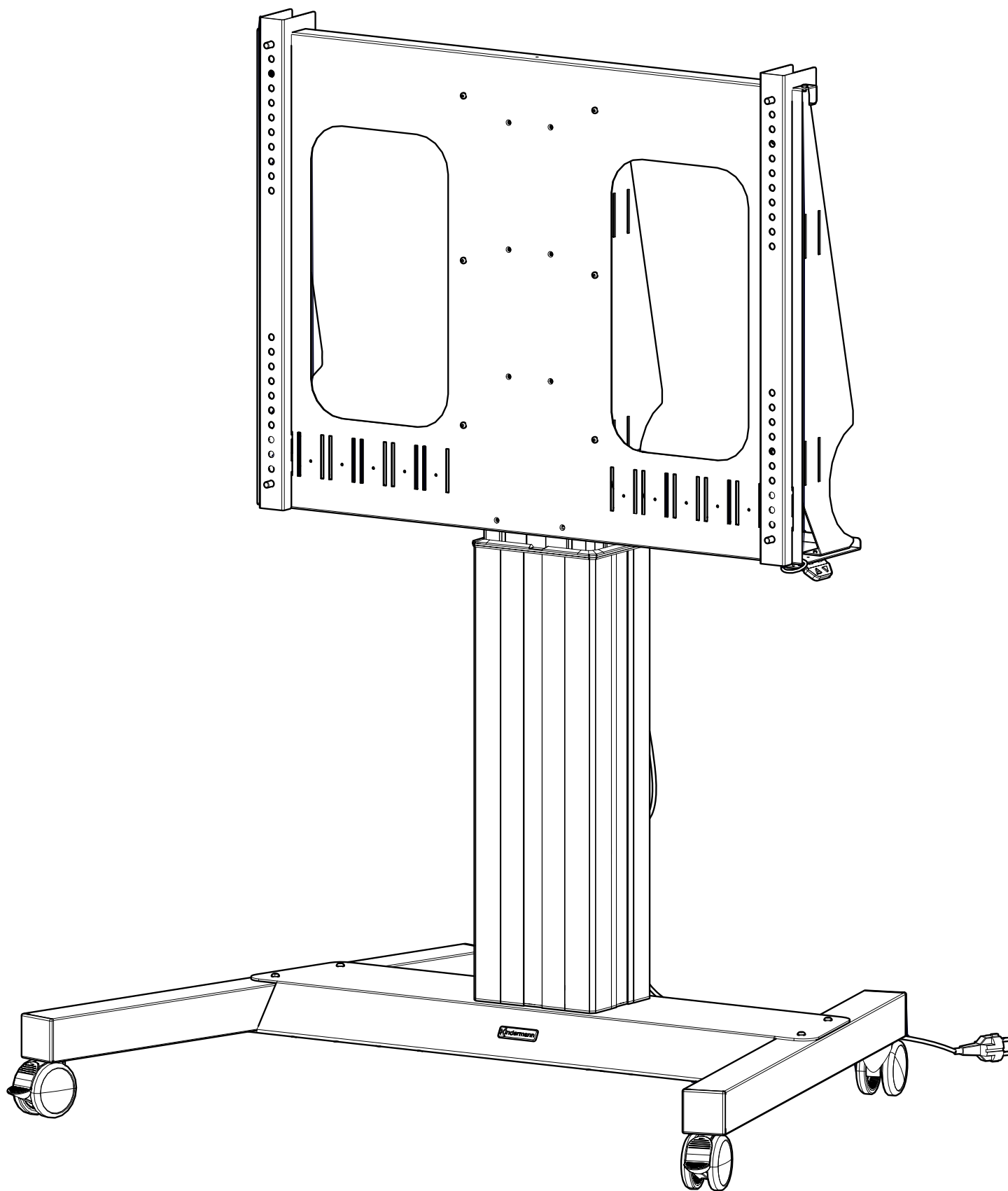

## 4.1 Lieferumfang – Scope of delivery

Art.-Nr./ Ref.No. 4013000301

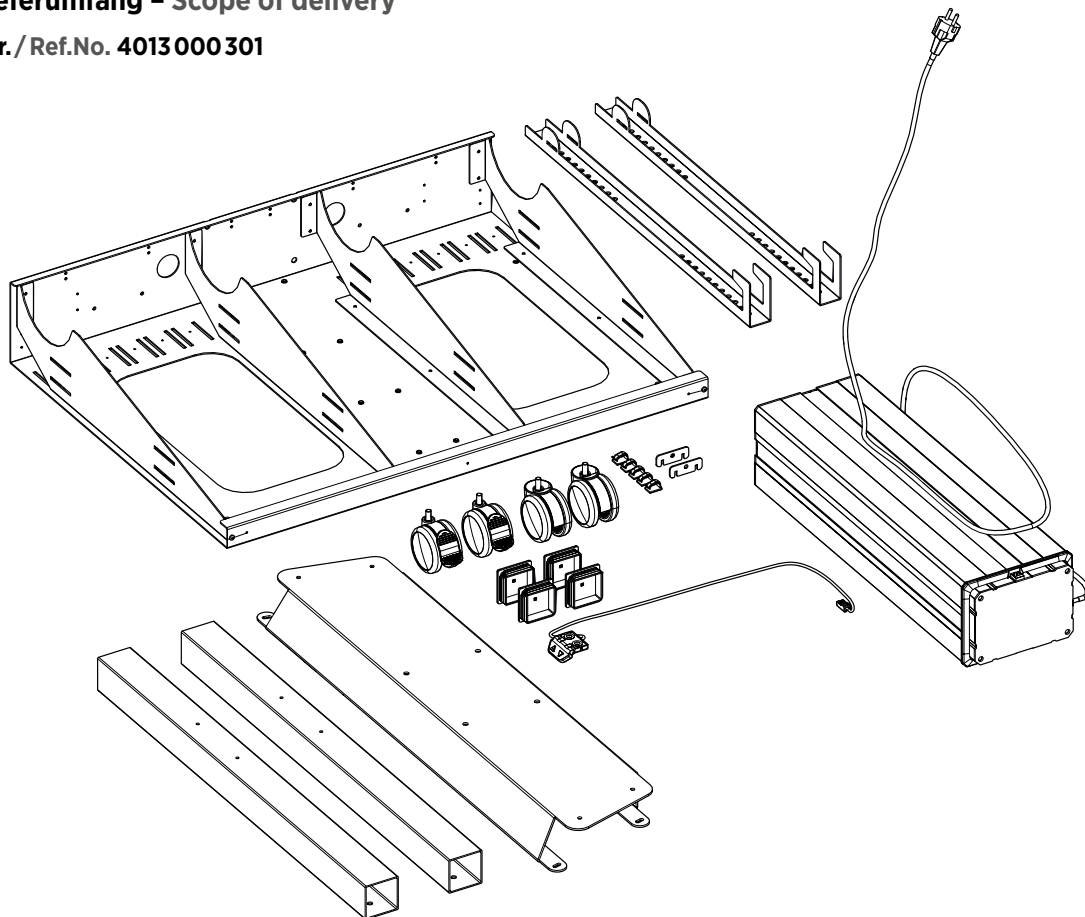

4 x M8



2 x 4,3mm



4 x 6,4mm



12 x 8,4mm



8 x 8,4mm



8 x M6x14mm

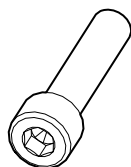

8 x M8x35mm  
(gewindeformend/  
thread-forming)



4 x M8x16mm



4 x M8x16mm



2 x M4x8mm



2 x M4x10mm

## 2.2 Benötigtes Werkzeug – Required tools



3, 5, 6



TX 20



13, 17

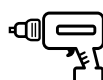

### 4.3 Montage - Assembling

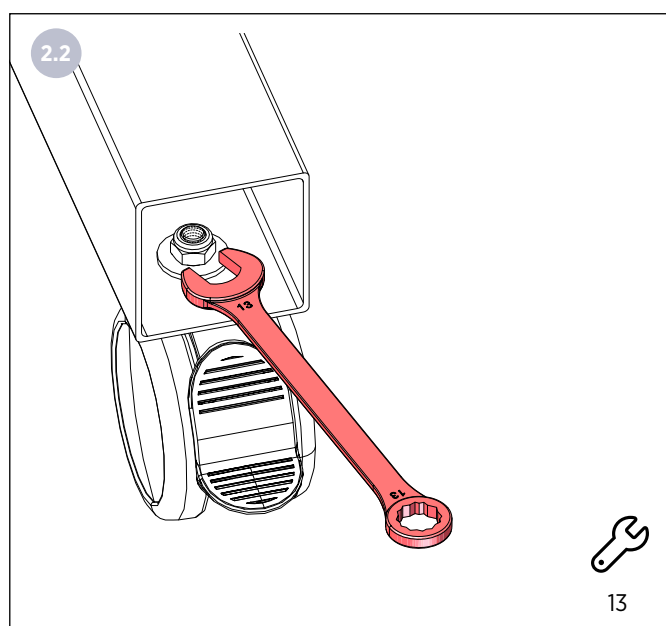
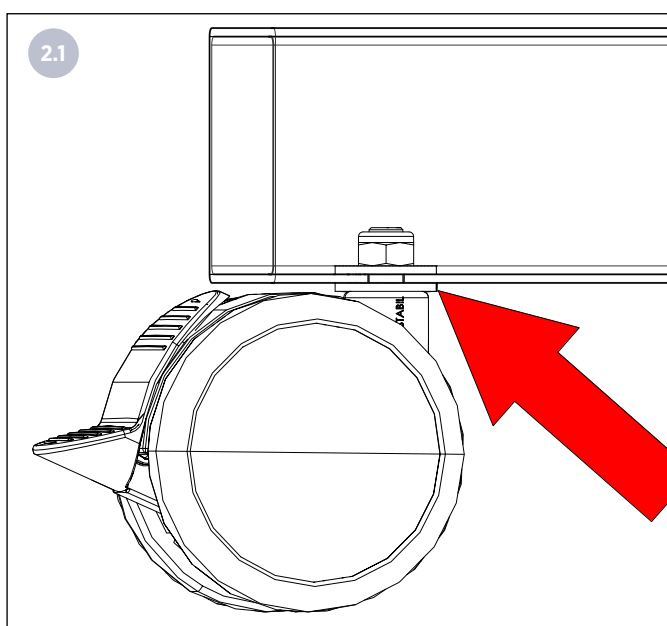
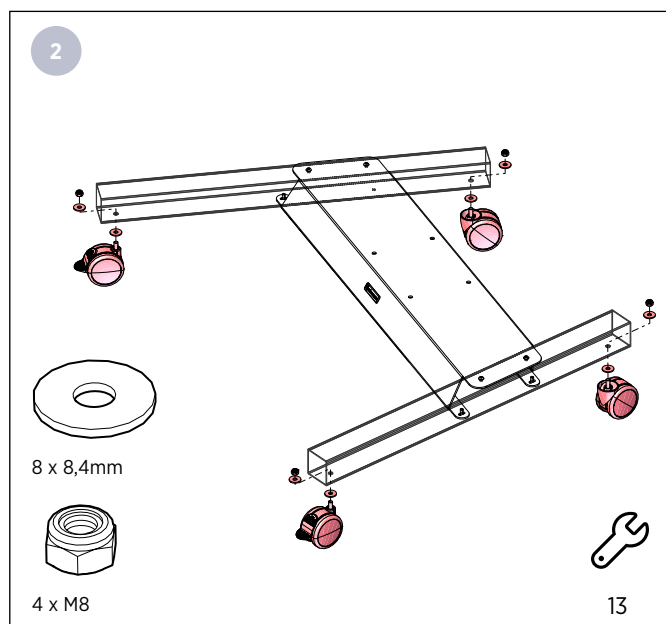
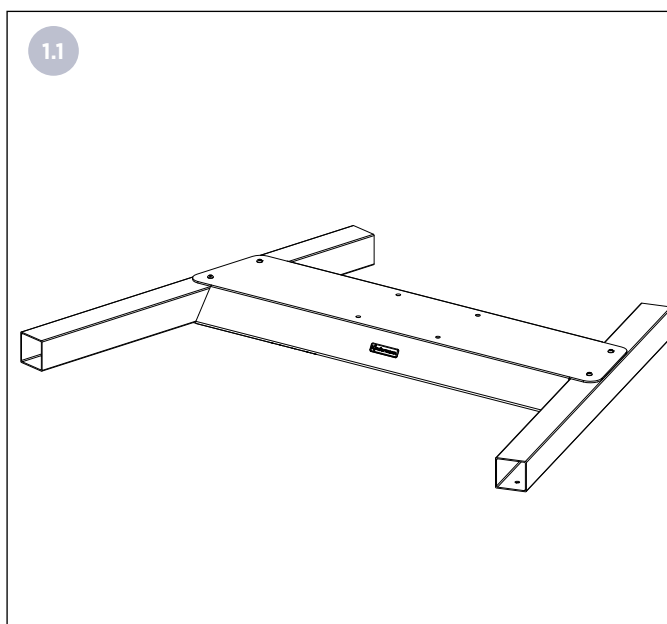
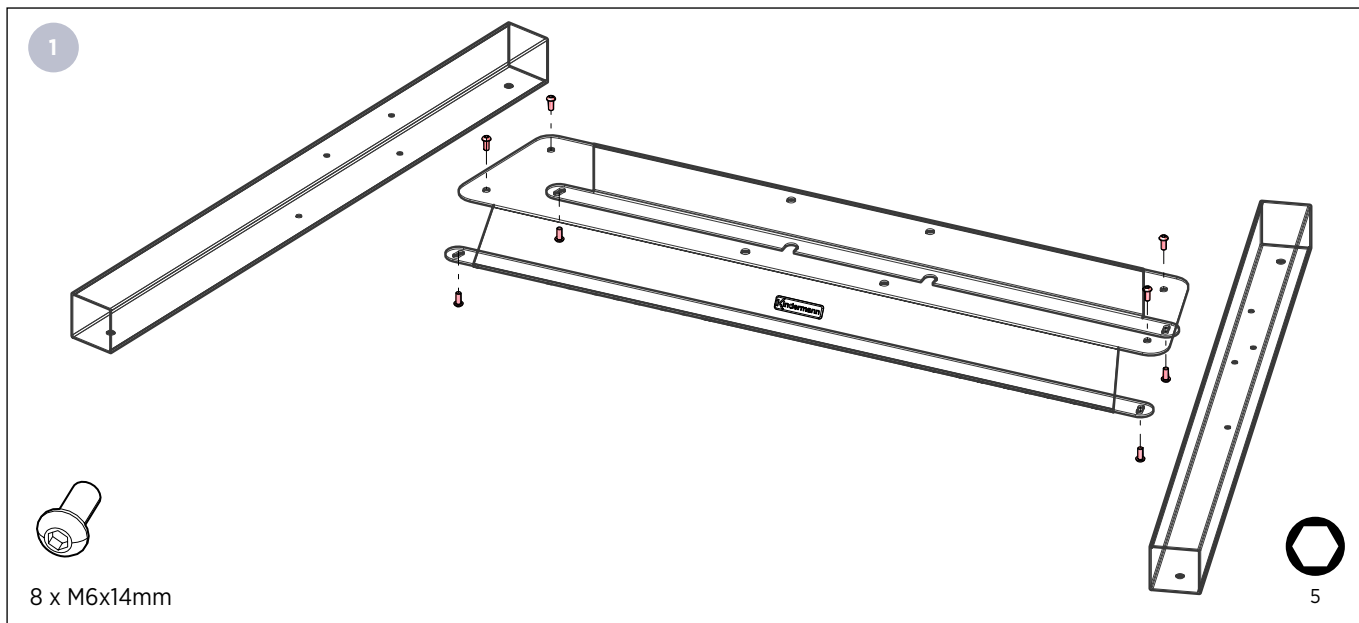

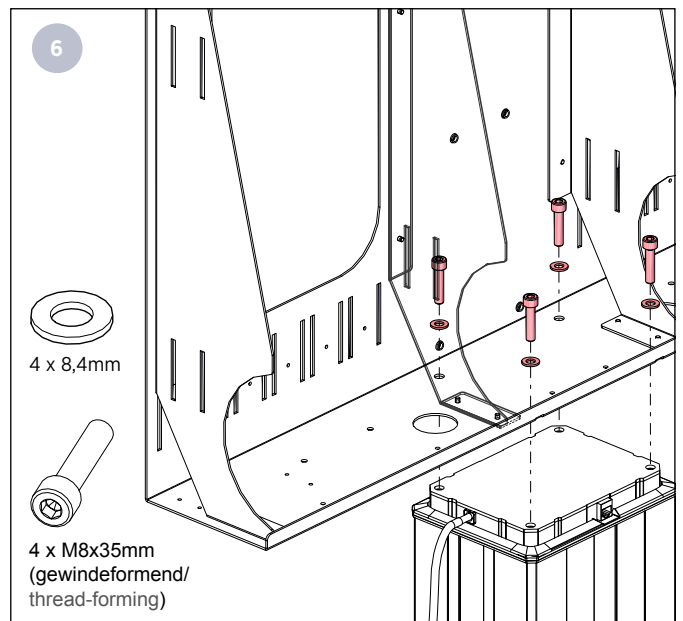
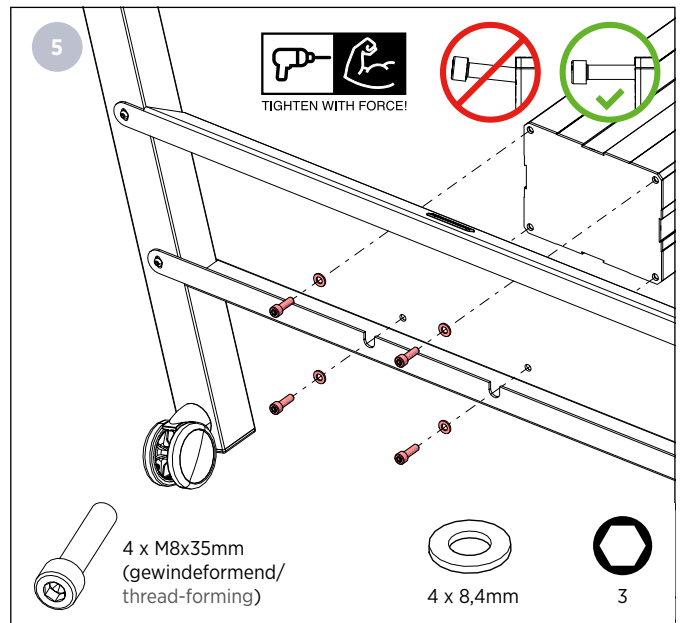
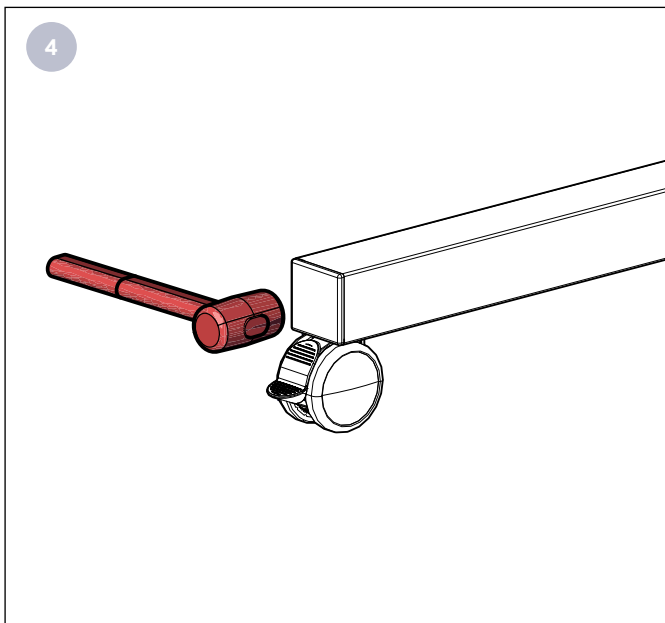
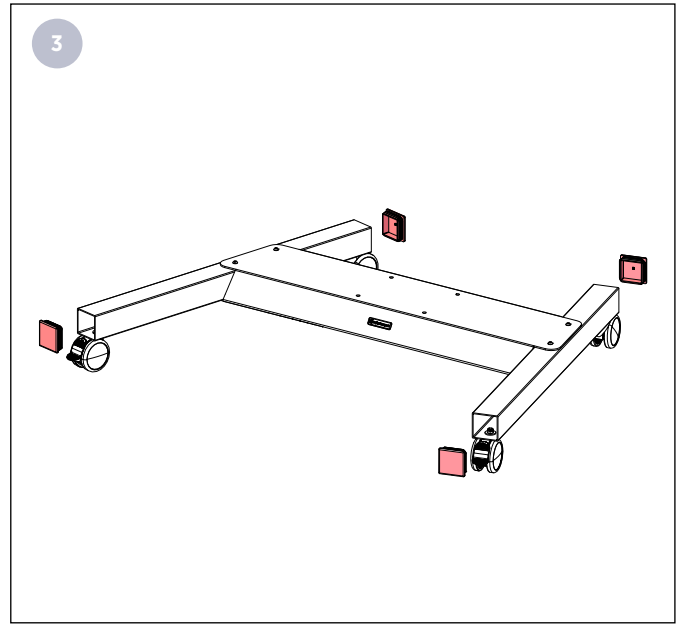
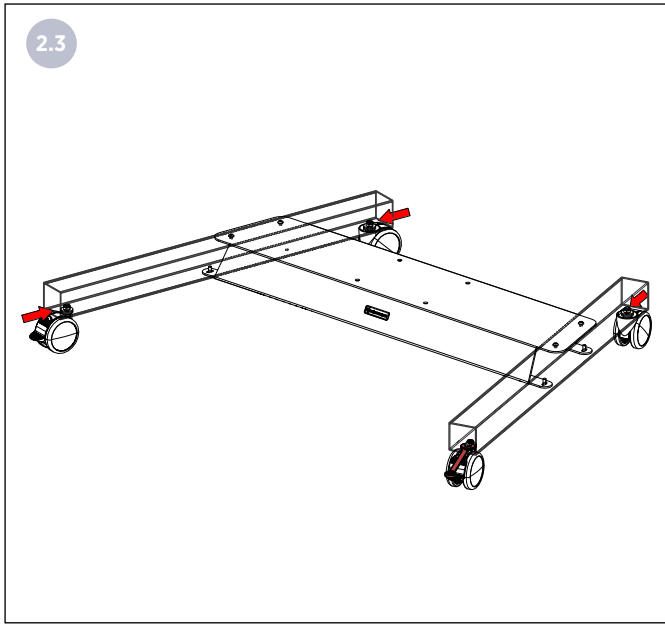



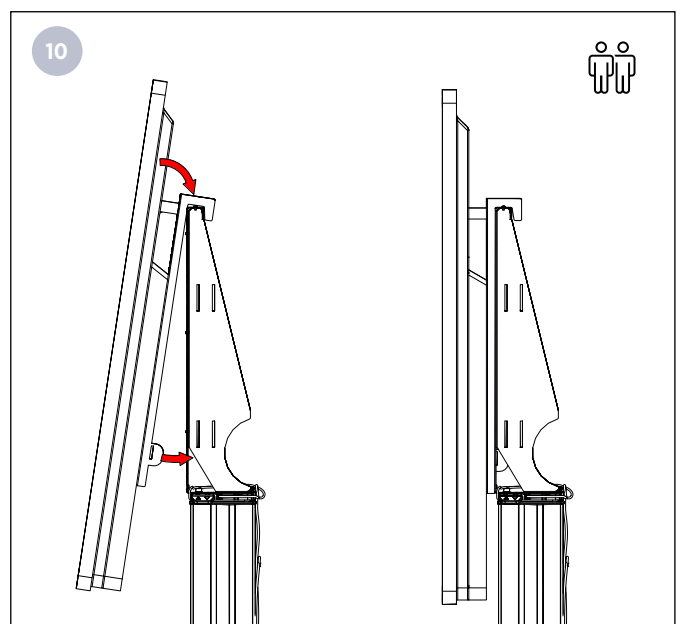
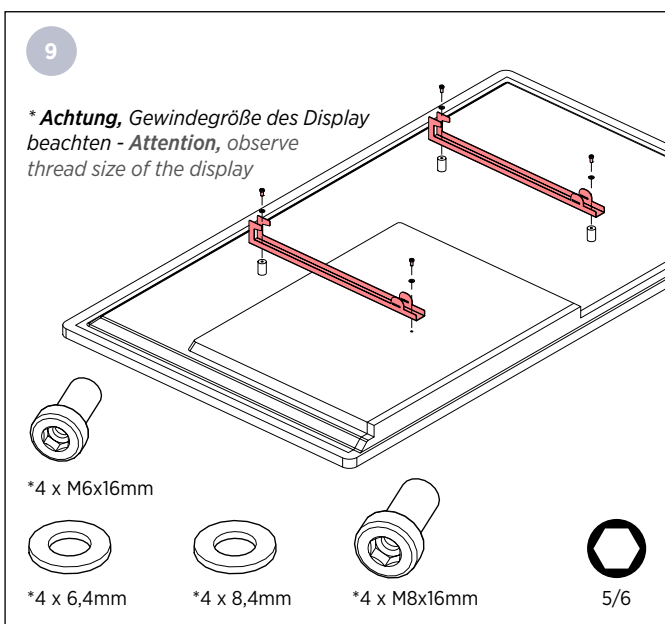
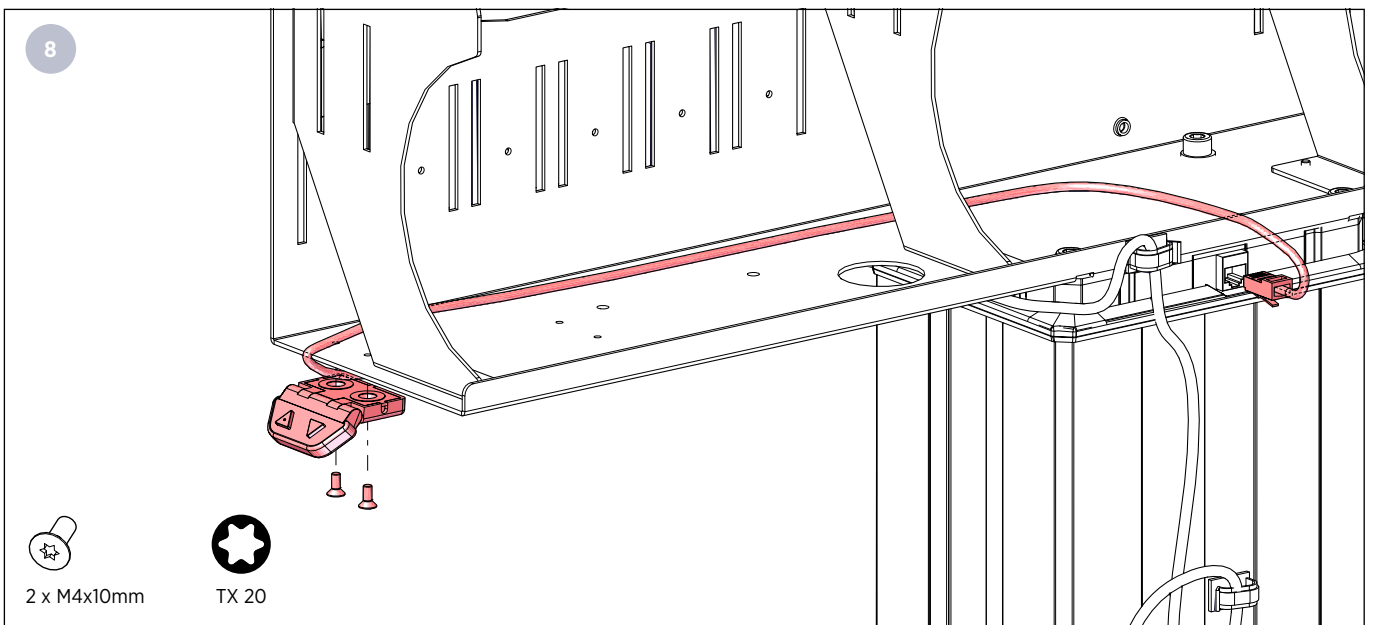
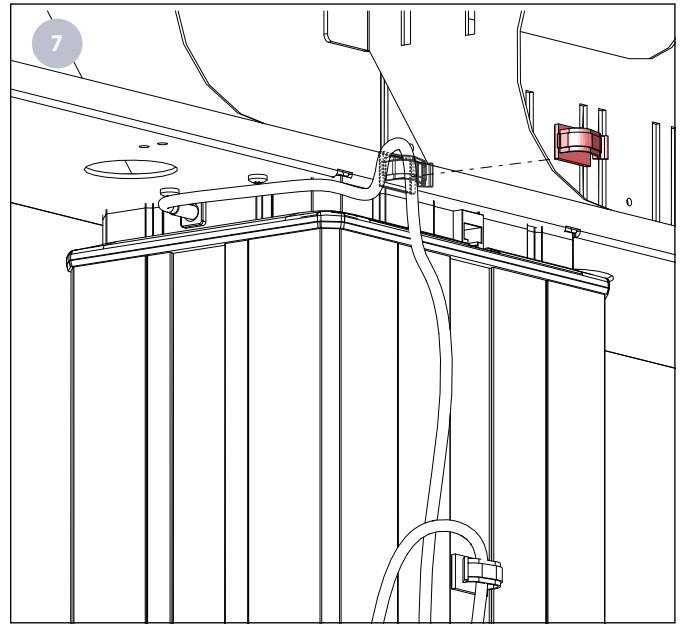
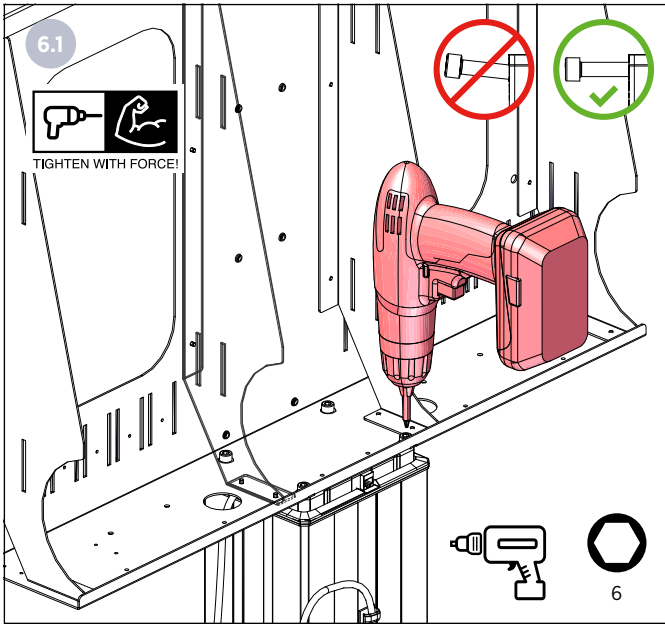

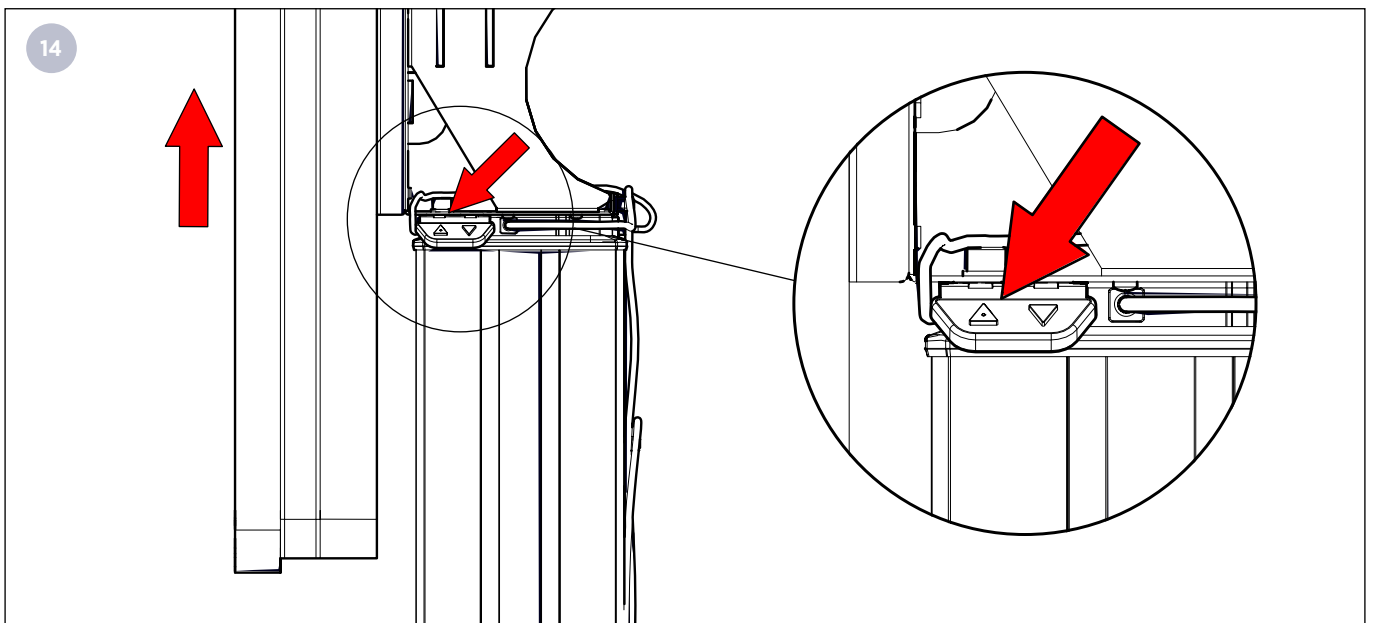
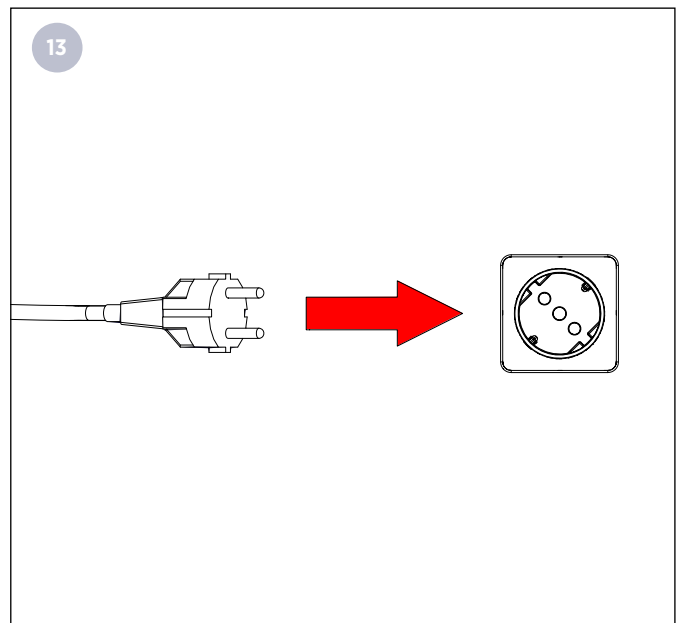
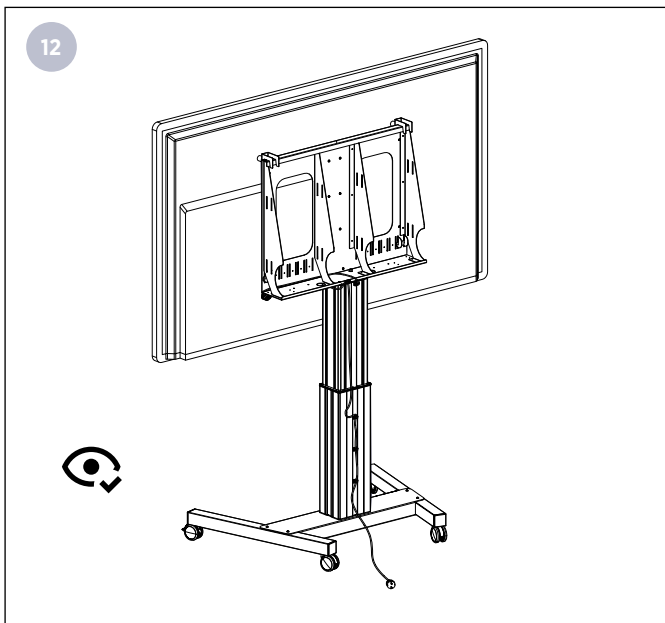
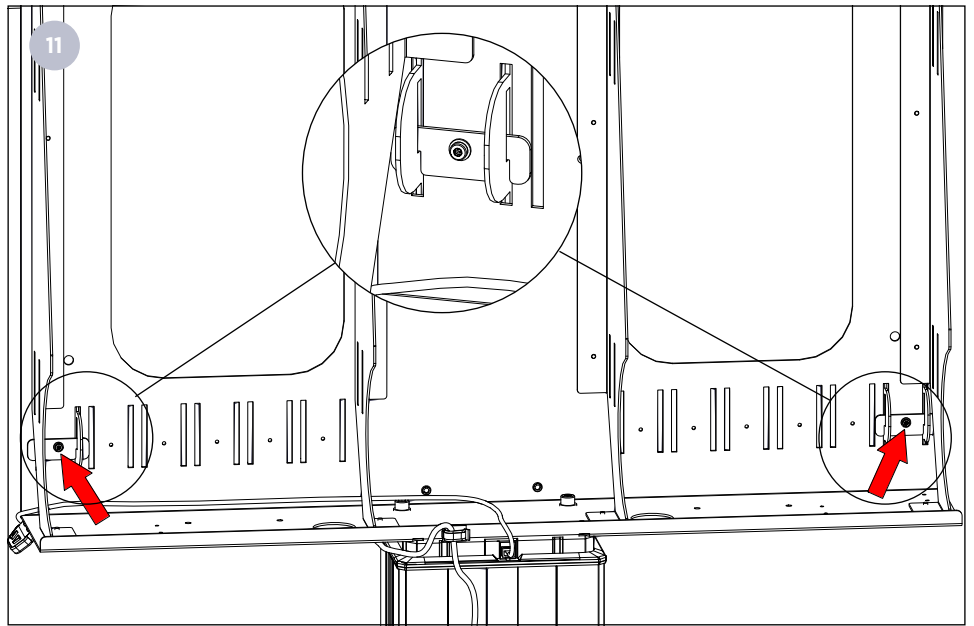
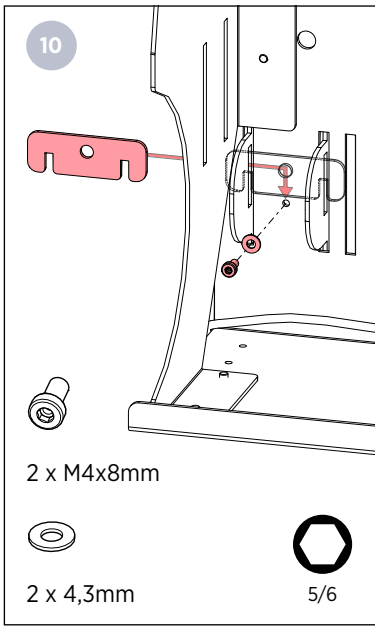

## 5. Abmessungen – Dimensions

Art.-Nr./Ref.No. 4013000300

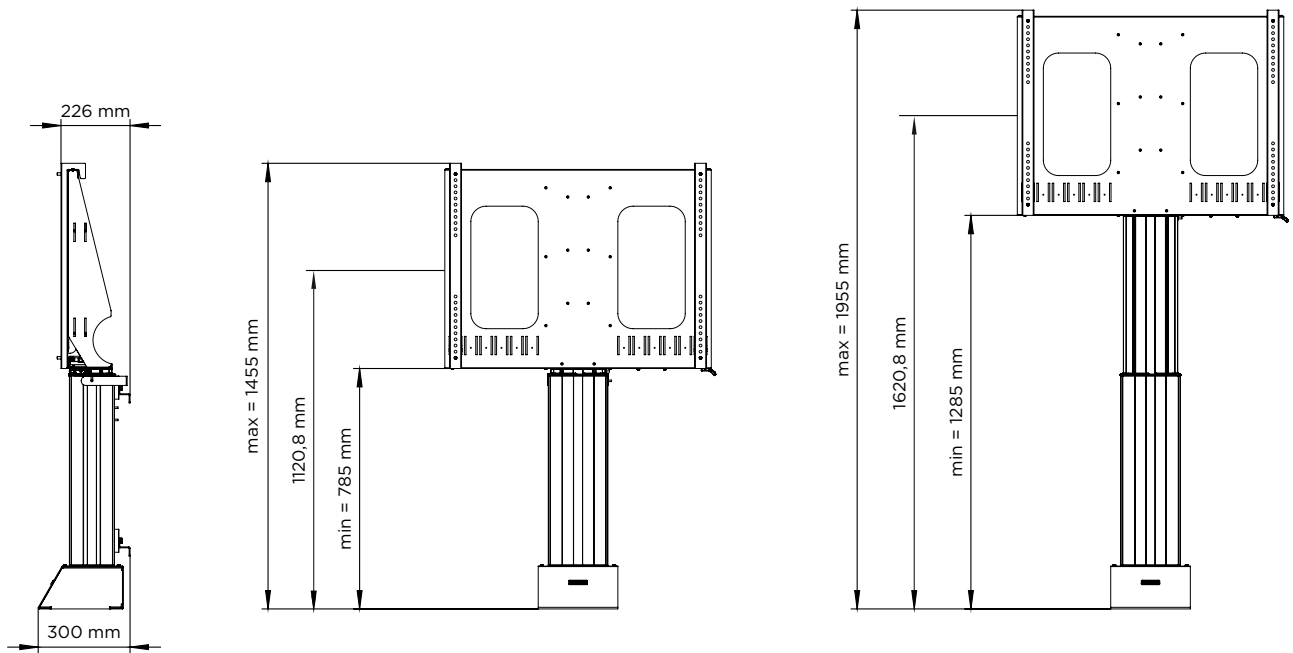

Art.-Nr./Ref.No. 4013000300 + 4013000110

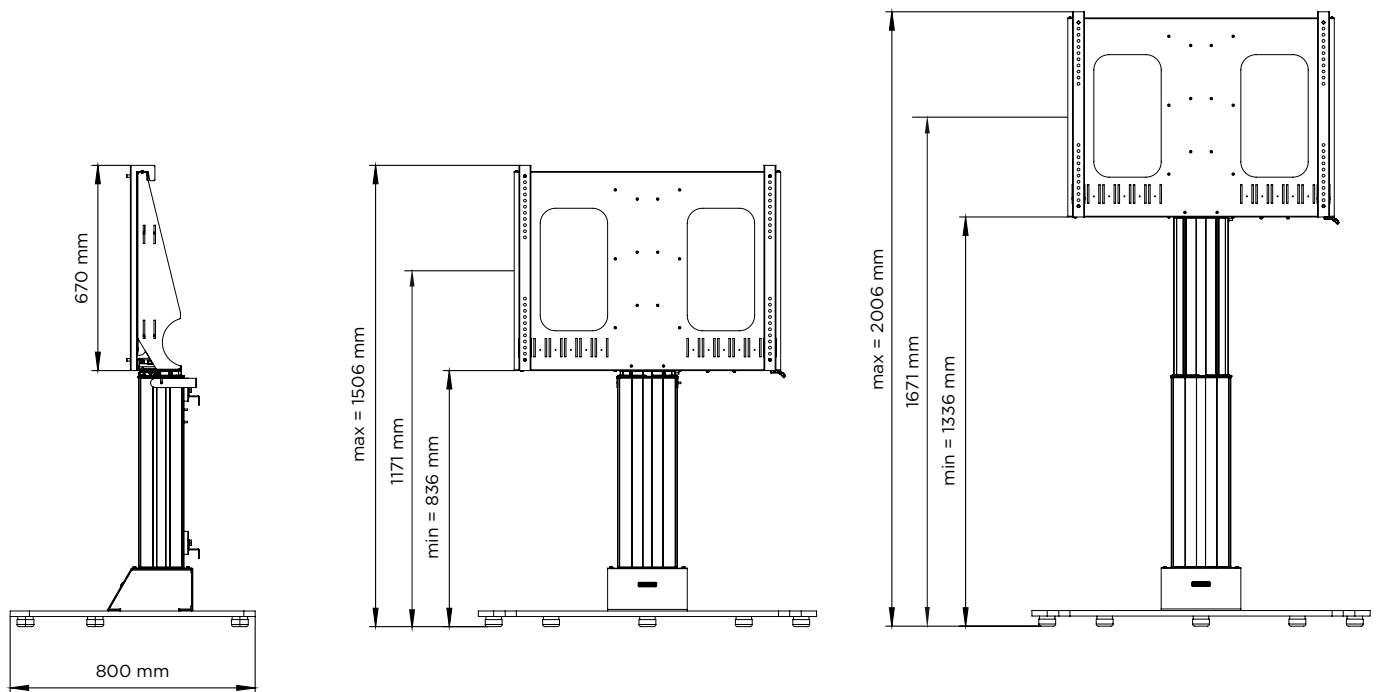

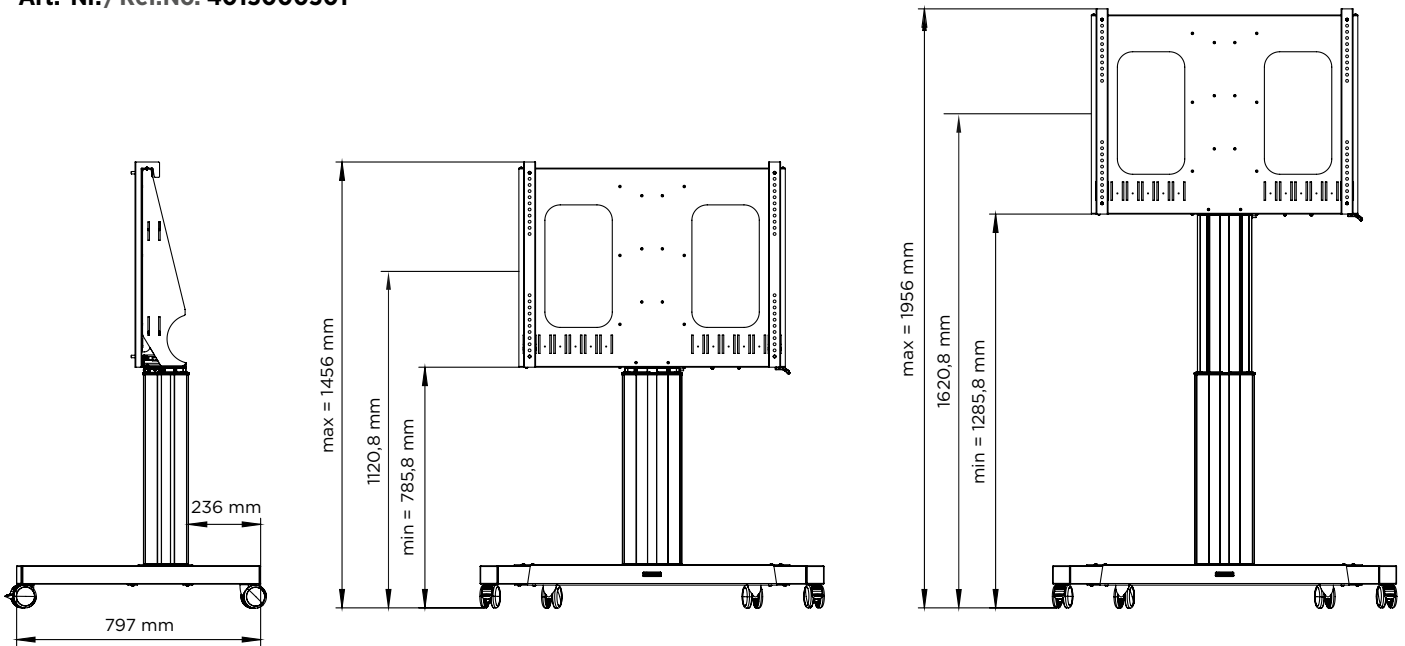

## 6. Spezifikationen – Specifications

	Art.-Nr. / Ref.No. 4013000300	Art.-Nr. / Ref.No. 4013000110	Art.-Nr. / Ref.No. 4013000301
Abmessungen ohne Display (BxHxD) Dimensions without display (WxHxD)	870 x 1455 (1955) x 321 mm	1105 x 1506 (2006) x 800 mm	1125 x 1455 (1955) x 800 mm
Gewicht ohne Display Weight without display	ca. 32 kg approx. 32 kg	Bodenplatte / base plate ca. 8 kg approx. 8 kg  Gesamt / entire ca. 40 kg approx. 40 kg	ca. 41 kg approx. 41 kg
Farbe Colour	RAL 9005 – Stahl pulverbeschichtet, tiefschwarz – eloxiertes Aluminium RAL 9005 – steel powdered, black – aluminium anodized		
VESA	300 x 200 - 800 x 600		
Höhenverstellung Height adjustment	50 cm		
Max. Gewicht Monitor Max. weight of display	90 kg		
Max. Größe Monitor Max. size of display	86 Zoll / Inch		
Transport-Verpackung Transport case	Karton 1: 80 x 95 x 200 cm: ca. 40 kg Box 1: 80 x 95 x 200 cm: approx. 40 kg  Hubsäule in Karton 2: 90 x 25 x 19 cm: ca. 14 kg Lifting pillar in Box 2: 90 x 25 x 19 cm: approx. 14 kg		

### Kindermann GmbH

Mainparkring 3 | 97246 Eibelstadt | Germany  
E-Mail: info@kindermann.de  
Subject to alterations | 842 228 | D/GB | 06.2022