

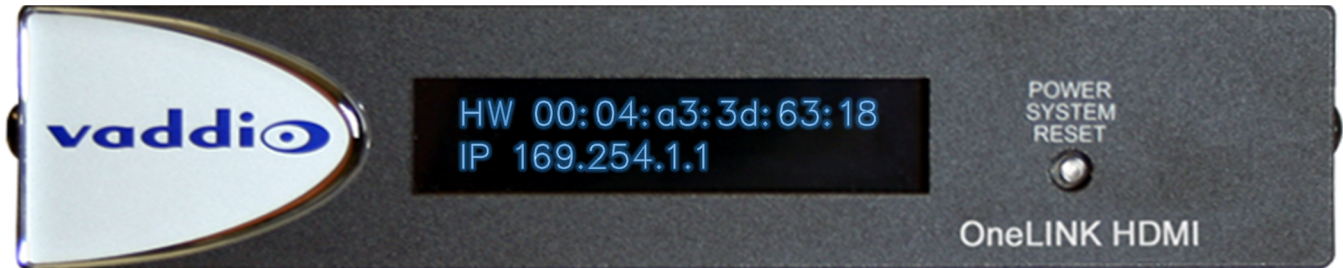

OneLINK™ Digital Camera Interface

Vaddio™ OneLINK System for Polycom® EagleEye IV Cameras Video, Power and Control over a Single Cat-5e or better Cable

Part Numbers: 999-9520-000 North America, 999-9520-001 International



Vaddio's OneLINK System for Polycom Group Series codecs and EagleEye IV cameras is digital camera extension system that extends HDMI video, power and control on a single Cat-5e or better cable at distances of up to 328' (100m). Simply put, OneLINK allows for simplified, economical and faster installations. The OneLINK system sends and regulates power to the EagleEye IV camera, provides a bi-directional control channel for RS-232 and transmits/receives uncompressed HDMI digital video up to 1080p/60 for the EagleEye IV and up to 2160p/30 for the future.

Images: OneLINK HDMI Digital Camera Interface Front Panel (above) and EZIM Camera Interface (below).



The system consists of the small EZIM™ (EZCamera™ Interface Module) camera interface at the camera end and the OneLINK HDMI interface at the codec end with all the required connective cables. The system comes complete with an awesome camera mount that also provides a convenient and unobtrusive mounting location for the EZIM and interface cables at the camera location. The EZIM provides the required camera connectivity and is mounted on the back wall of a heavy duty gusseted wall bracket with mounting accommodation for the EagleEye IV camera. This Vaddio style gusseted wall bracket can be mounted directly to a 2-gang sized electrical box, allowing for a professional and safe installation in a conduit system.

From one end to the other, the OneLINK system provides system integrators and end users a simplified product based on the vast experience Vaddio has in cameras and cable extension systems, which itself is the means to a positive end.

WHAT'S INCLUDED

The OneLINK System includes the following devices to extend the EagleEye IV camera:

- One (1) OneLINK HDMI Digital Camera Interface unit for the codec side.
- One (1) OneLINK EZIM (EZCamera Interface Module) for the camera side.
- One (1) 48 VDC, 1.37 Amp Switching Power supply
- One AC Cord Set (for North America or International)
- One (1) Mini HDCI to HDMI, RS-232 & Power plugs for the camera side.
- One (1) HDCI to HDMI, RS-232 & Power plugs for the codec side.
- One (1) Quick Start Guide for OneLINK

Note: Full length manuals are downloaded from vaddio.com

KEY TECHNICAL FEATURES

Single Cat-5e/6/7 Cable Solution

The OneLINK System requires a single Cat-5e cable to transport power to the PTZ camera, provide bi-directional RS-232 communication and return HDMI from the camera up to a distance of 328' (100m).

The Technology

Vaddio's product group has relentlessly strived to use the newest, the best, most relevant and standards based (HDBaseT) technologies available today. The OneLINK HDMI is simply the result.

Another Fine Point

The OneLINK system was conceived, designed and manufactured in the USA at Vaddio's HQ in Minnetonka, Minnesota.



SYSTEM DRAWING

Configuration Example

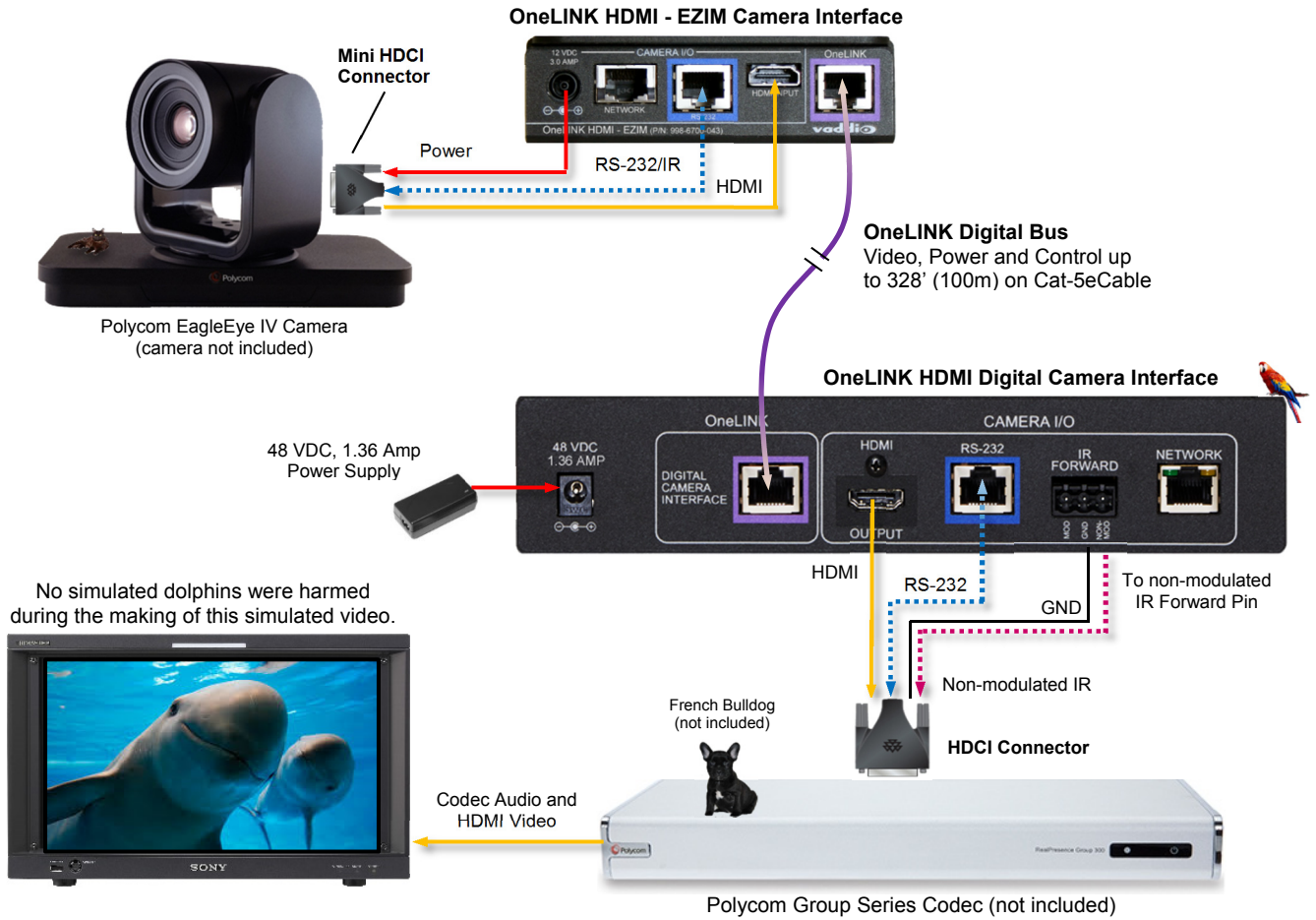

GENERAL SPECIFICATIONS

Vaddio OneLINK for EagleEye IV

Part Numbers	999-9520-000: OneLINK System for Polycom EagleEye IV (North America), 999-9520-001: OneLINK System for Polycom EagleEye IV (International)
Compatible Camera	Polycom EagleEye IV Cameras (cameras not included) Camera cable kit included
Compatible Codecs	Polycom Group Series Codecs (codecs not included) Codec cable kit included
Supported Resolutions	Up to 1080p/60 for the EagleEye IV and up to 2160p/30 for the future
Control Support	RS-232 and IR
Camera Power Support	12 VDC, 3 Amp from EZIM to Camera.
Cabling Max. Distances	328' (100m) over Cat-5e (Best Practices - When in doubt of EMI or RF interference in the area that OneLINK is being installed, use shielded Cat-6 cable).
Connectors on OneLINK Interface	OneLINK Port on Shielded RJ-45F, HDMI Output Receptacle, Ethernet on shielded RJ-45F with LEDs, RS-232 on shielded RJ-45 connector, Power on 2.5mm x 5.5mm coaxial connector, IR Forward on 3-pin 5.0mm Phoenix-style connector
Connectors on OneLINK EZIM	OneLINK Port on Shielded RJ-45F, HDMI Receptacle, Ethernet on shielded RJ-45F with LEDs, RS-232 and IR on shielded RJ-45 connector, Power on EIAJ-04
OneLINK Power Supply	48 VDC, 1.37 Amp Switching Power Supply for the OneLINK Interface
OneLINK Interface Dimensions (H x W x D - not including space-time)	1.72" (43.7mm) H x 8.375" (212.7mm) W x 6.00" (152.4mm) D
OneLINK EZIM Dimensions (H x W x D)	3.861" (98.07mm) H x 4.310" (109.47mm) W x 1.24" (31.5mm) D
OneLINK EZIM Weight	0.553 lbs. (0.251kg)
OneLINK Interface Weight	1.553 lbs. (0.704kg)
Operating Temperature/Humidity	0°C (32°F) to 40°C (104°F), 20% to 80% Relative Humidity

Learn more about our cameras, audio devices and controllers at 800-572-2011 or vaddio.com

©2015 Vaddio - All Rights Reserved. Reproduction in whole or part without written permission is prohibited. Specifications and pricing are subject to change without prior notice or obligation. Vaddio, OneLINK, EZIM and EZCamera are trademarks of Vaddio. All other trademarks are the property of their respective owners. Preliminary Document 00110315-2 Rev B SD: 69305.1

vaddio

