

Area		NORTH AMERICA	EUROPE	CHINA
Model Name		FW-85BZ35L	FW-85BZ35L	FW-85BZ35L
SV No.		SV-41407	SV-41541	SV-41515
DIMENSION	TV only (W x H x D)	1899 x 1089 x 71 mm / 74 7/8 x 42 7/8 x 2 7/8 inch	Approx. 189.9 x 108.9 x 7.1 cm	Approx. 1899 x 1089 x 71 mm
	TV only with camera (W x H x D)	-	-	-
	TV with Stand (Standard position) (W x H x D)	1899 x 1176 x 456 mm / 74 7/8 x 46 3/8 x 18 inch	Approx. 189.9 x 117.6 x 45.6 cm	Approx. 1899 x 1176 x 456 mm
	TV with Stand (Narrow position) (W x H x D)	-	-	-
	TV with Stand (Soundbar position) (W x H x D)	-	-	-
	TV with Stand (Front position style) (W x H x D)	-	-	-
	TV with Stand (Back position style) (W x H x D)	-	-	-
	TV with Floor Stand (W x H x D)	-	-	-
	Stand Width (Standard position)	1532 mm / 60 3/8 inch	Approx. 153.2 cm	Approx. 1532 mm
	Stand Width (Narrow position)	-	-	-
	Stand Width (Soundbar position)	-	-	-
	Stand Width (Front position style)	-	-	-
	Stand Width (Back position style)	-	-	-
	Floor Stand Width	-	-	-
VESA Hole Pitch		400 x 400 mm / 15 3/4 x 15 3/4 inch	40.0 x 40.0 cm	400 x 400 mm
WEIGHT	TV Only	44.5 kg / 98.1 lb	Approx. 44.5 kg	Approx. 44.5 kg
	TV with Stand (Standard position)	46 kg / 101.4 lb	Approx. 46 kg	Approx. 46 kg
	TV with Stand (Narrow position)	-	-	-
	TV with Stand (Soundbar position)	-	-	-
	TV with Stand (Front/Back position style)	-	-	-
	TV with Floor Stand	-	-	-
	Floor Stand weight (Supply)	-	-	-
W-M t Br. Weight (Supply)	-	-	-	
Remarks		Optional stand	Optional stand	

WITH STAND

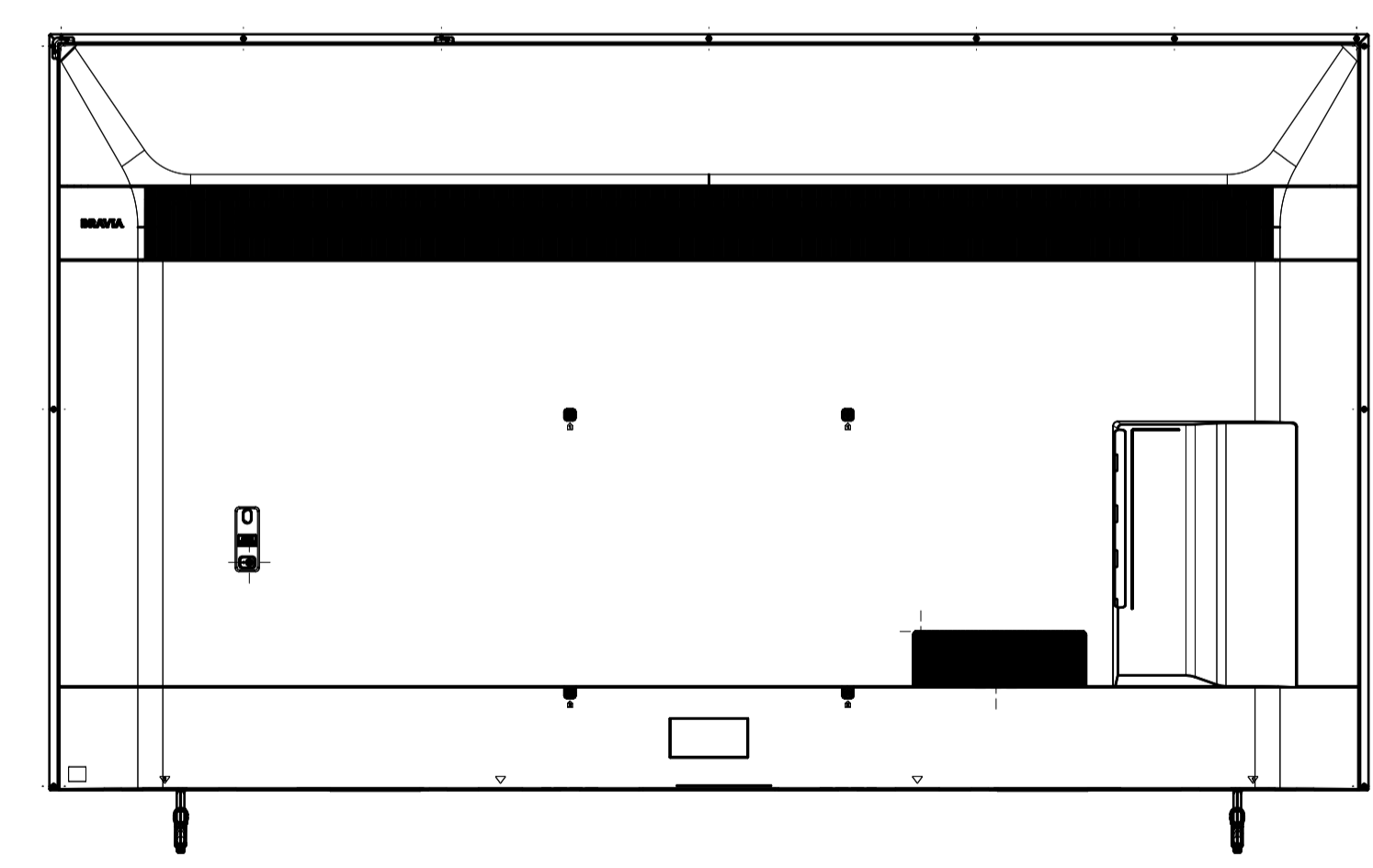
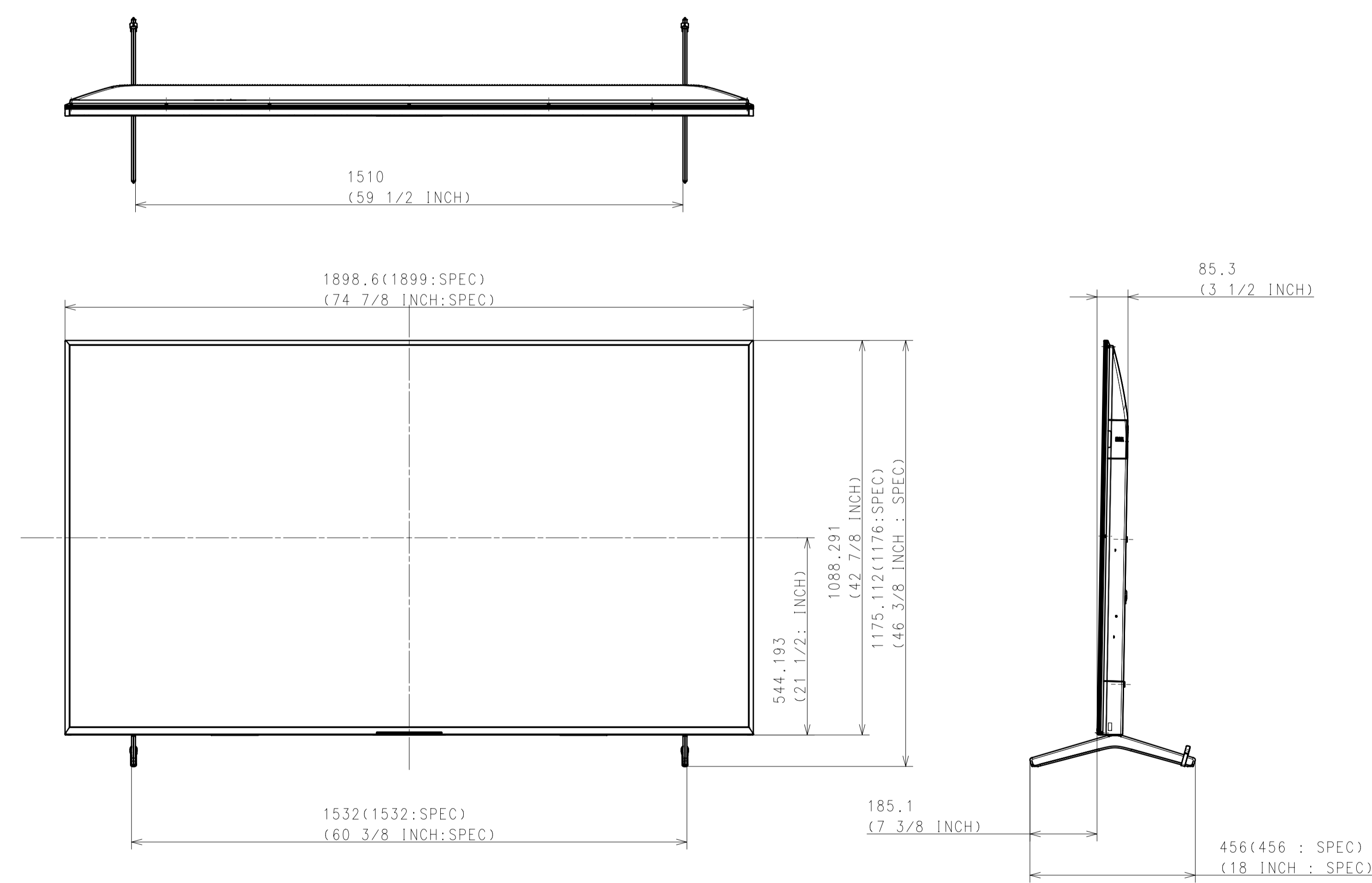

Purchase recycled resins and wire rods only from the business partners that Sony approves as Green Partners.

DATE OF ISSUE	2023.01.09	DOCUMENT TYPE	ASSEMBLY DRAWING
TOLERANCE		FINISH(COLOR)	
REVISION		SIGN.	
RESPONSIBLE DEPARTMENT	PANEL & MECHANICAL DESIGN		ORIGINAL MODEL
PLANNED BY	CHECKED BY	APPROVED BY	SCALE
SCALE	1:10	TENTATIVE MODEL	DESCRIPTION
DESCRIPTION	85(BZ35L) EXTERIOR VIEW		DESCRIPTION
DESCRIPTION	85(BZ35L) EXTERIOR VIEW		DESCRIPTION
SIZE	A1	UNIT	mm
SHEET/PAGES	1/3	SUFFIX	REV. NO.

WITHOUT STAND

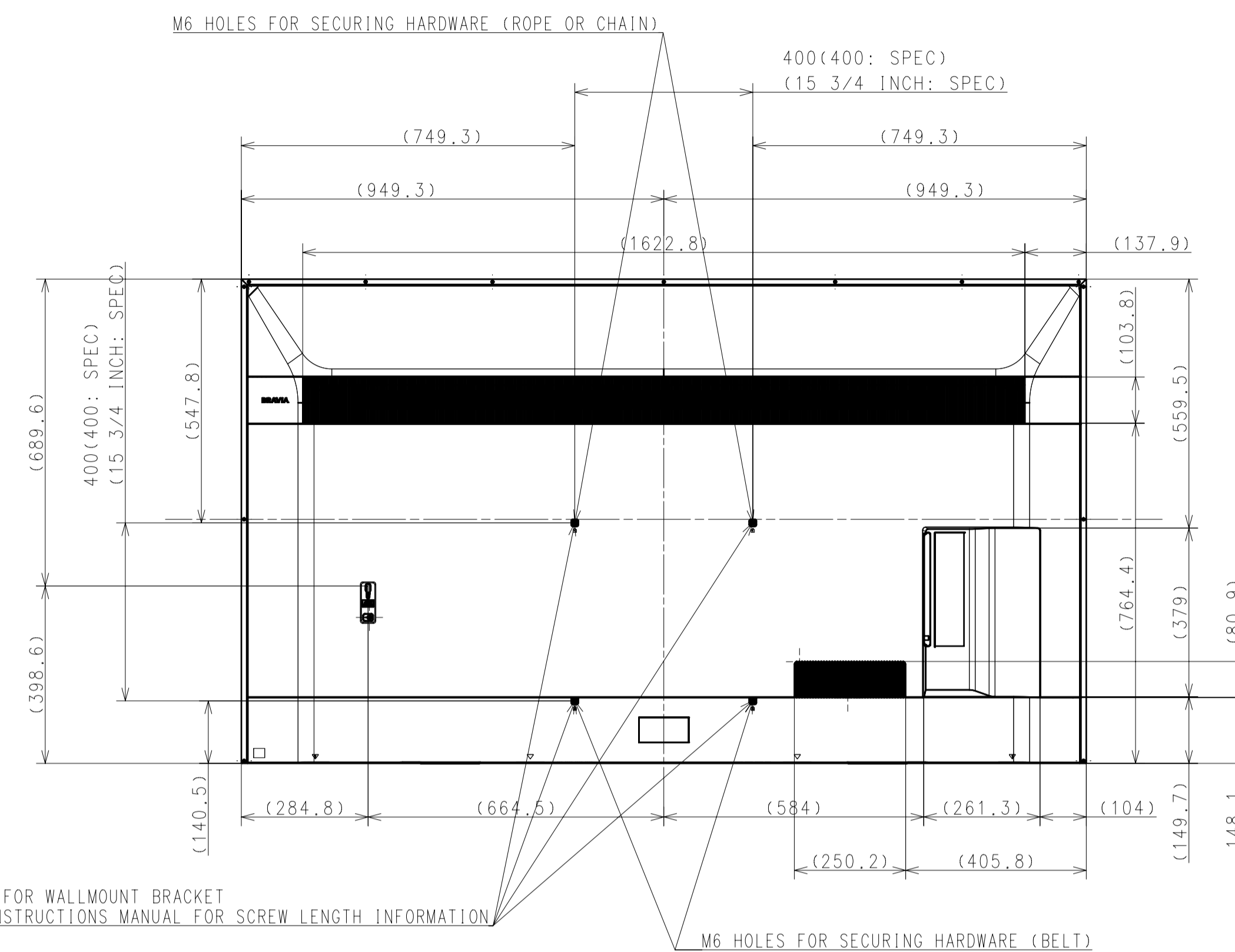
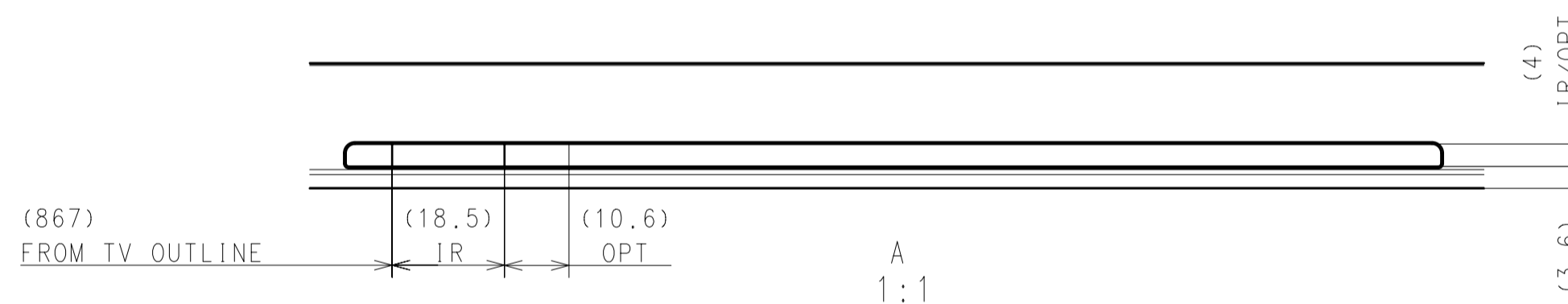
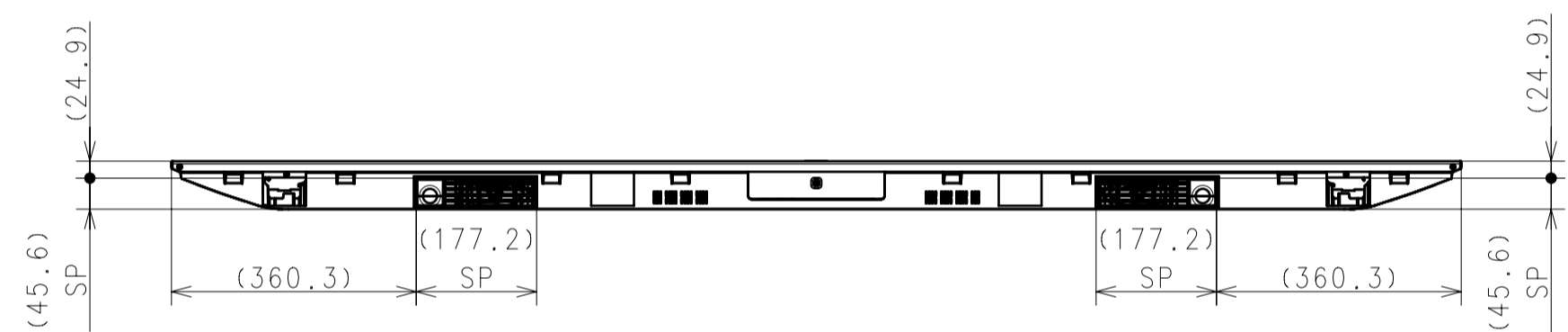
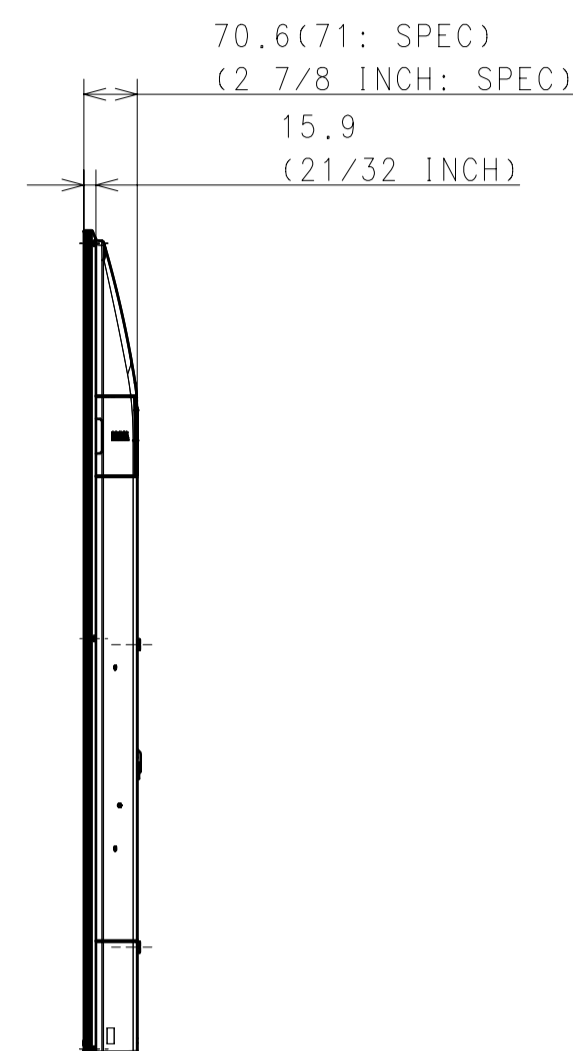
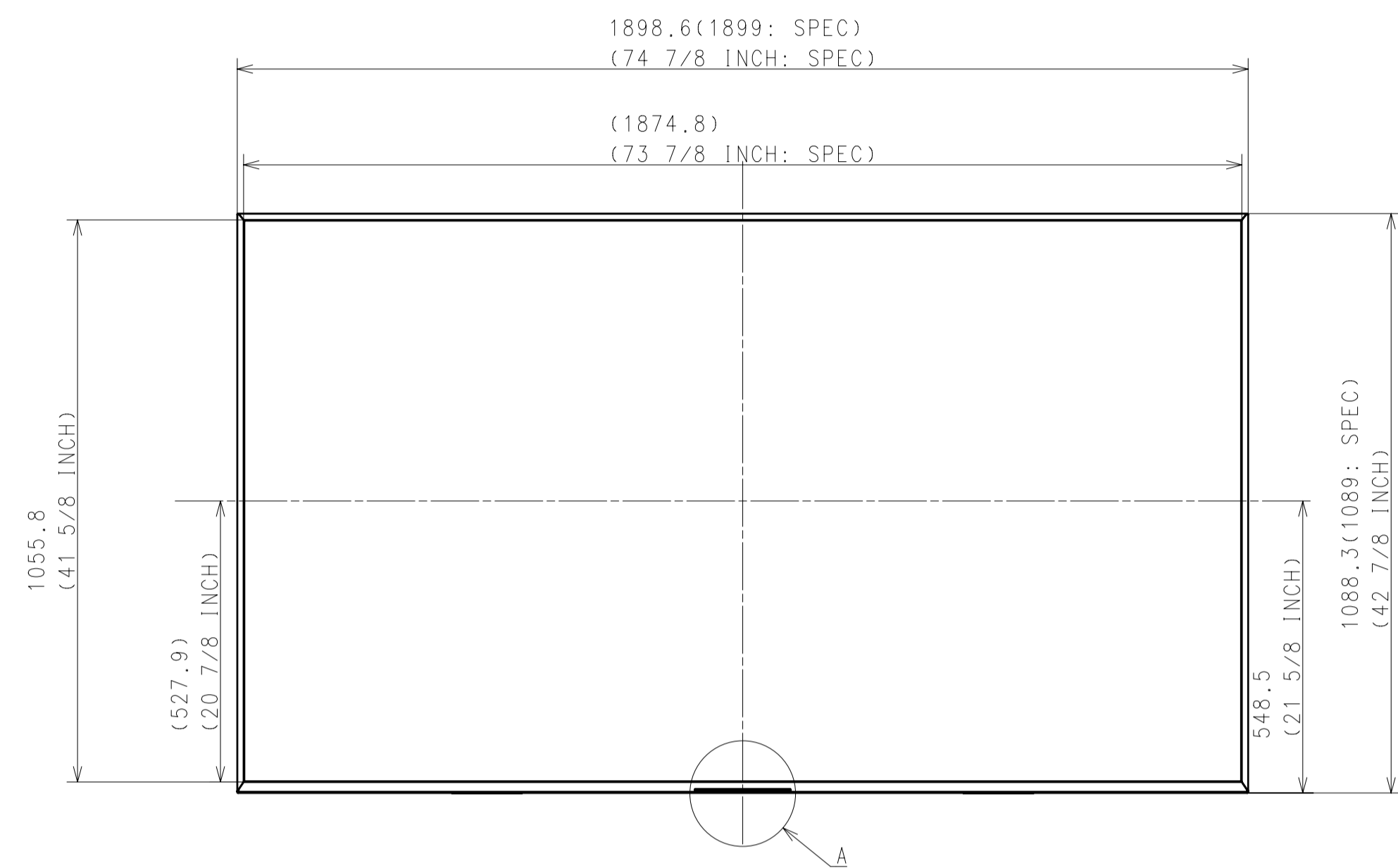

M6 HOLES FOR WALLMOUNT BRACKET  
#REFER INSTRUCTIONS MANUAL FOR SCREW LENGTH INFORMATION

M6 HOLES FOR SECURING HARDWARE (ROPE OR CHAIN)

M6 HOLES FOR SECURING HARDWARE (BELT)

For NORTH AMERICA, EUROPE, CHINA

DESCRIPTION 1	85(BZ35L) EXTERIOR VIEW	LEGAL OWNER	Sony Corporation	SCALE	1:1
DESCRIPTION 2	85(BZ35L) EXTERIOR VIEW	PART NO.		SHEET/PAGES	2 / 3

SU\_WL450 SLIM

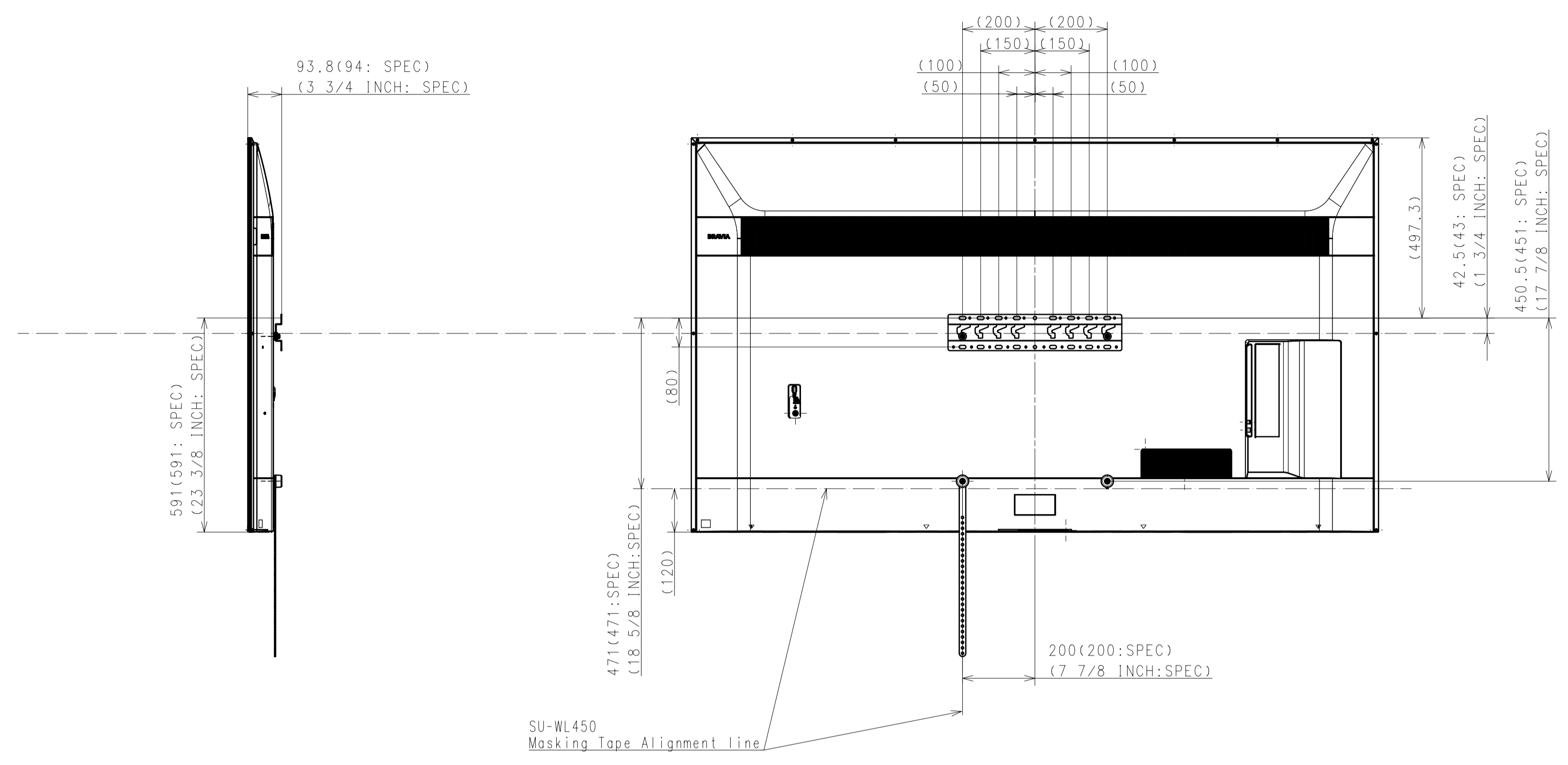

SU\_WL450 STANDARD

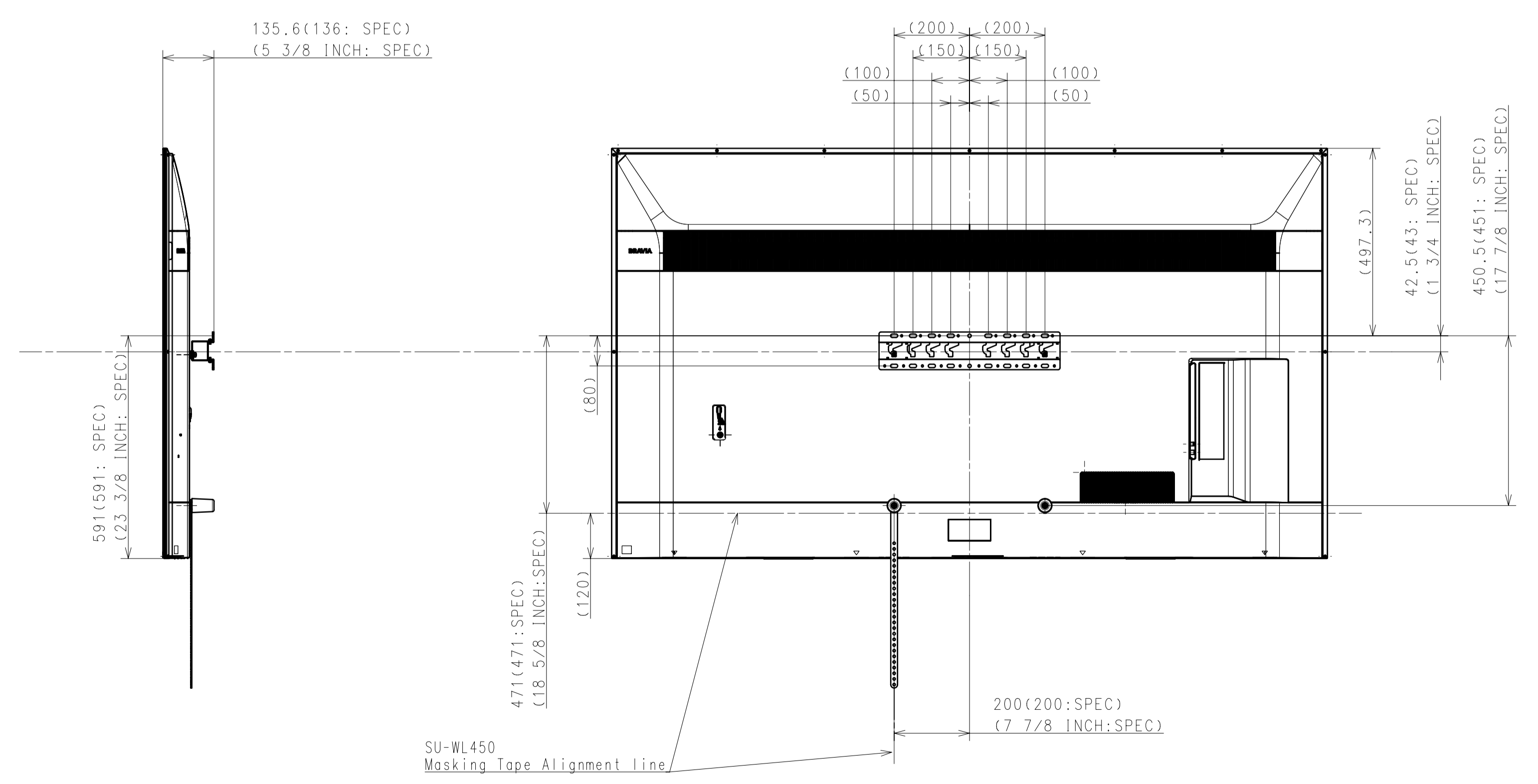

DESCRIPTION	LEGAL OWNER	SCALE
85(BZ35L) EXTERIOR VIEW	Sony Corporation	1:1
85(BZ35L) EXTERIOR VIEW	PART NO.	SHEET/PAGES 3 / 3